

GS-H

G1 (X 80 - 95) = 130
 G1 (X < 80) = 120 / G2 = 120

428,5
 428,5

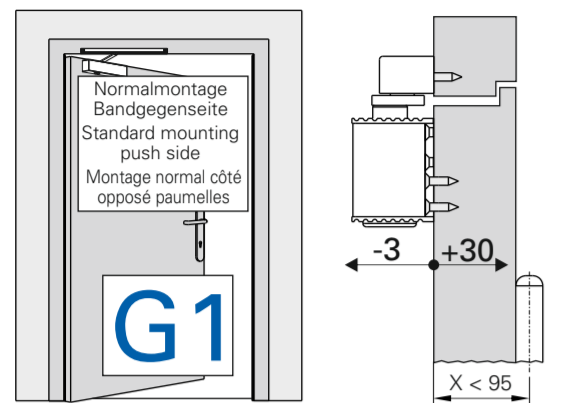

G1 = 122
 G2 = 142

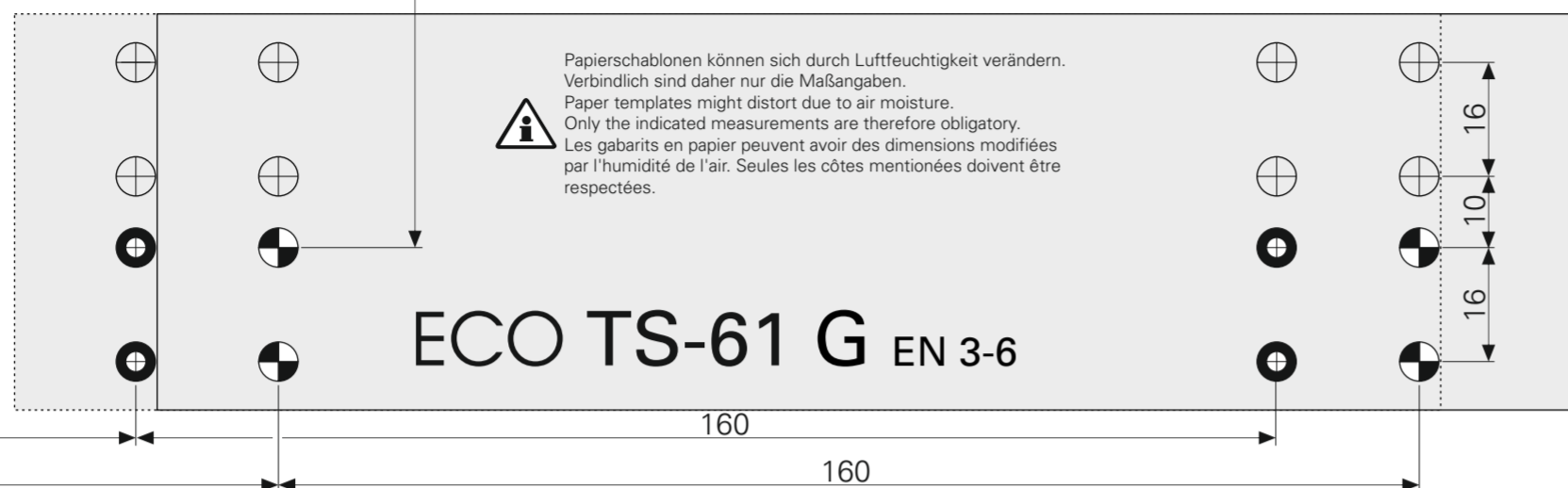

Papierschablonen können sich durch Luftfeuchtigkeit verändern. Verbindlich sind daher nur die Maßangaben.
 Paper templates might distort due to air moisture. Only the indicated measurements are therefore obligatory.
 Les gabarits en papier peuvent avoir des dimensions modifiées par l'humidité de l'air. Seules les côtes mentionnées doivent être respectées.

- Lochgruppe für Normalmontage Bandgegenseite
 Drillings for standard mounting push side
 Alésage pour montage normal côté opposé paumelles
- Lochgruppe für Kopfmontage Bandseite
 Drillings for head mounting pull side
 Alésage pour montage inversé côté paumelles

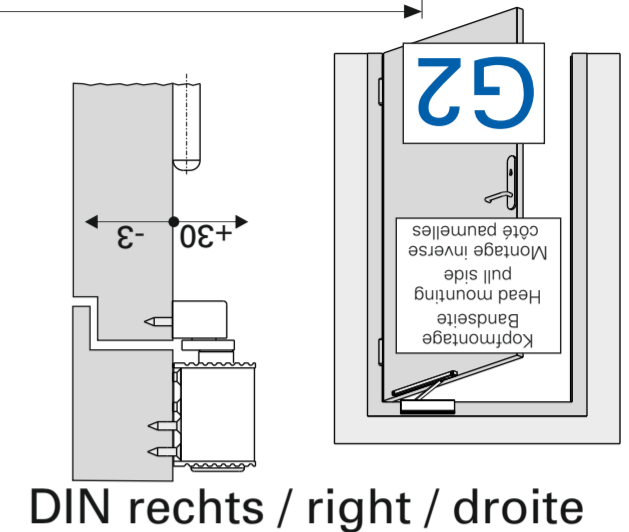

DIN rechts / right / droite

ECO TS-61 G EN 3-6

CE	ECO Schulte GmbH & Co. KG Iserlohner Landstraße 89 D-58706 Menden	22
0432-CPR-00099-12	EN 1154:1996+A1:2002 / AC:2006	4 8 3-6 1 1 4

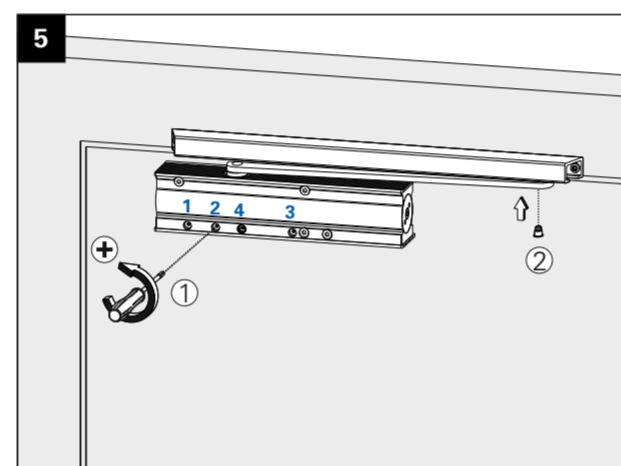
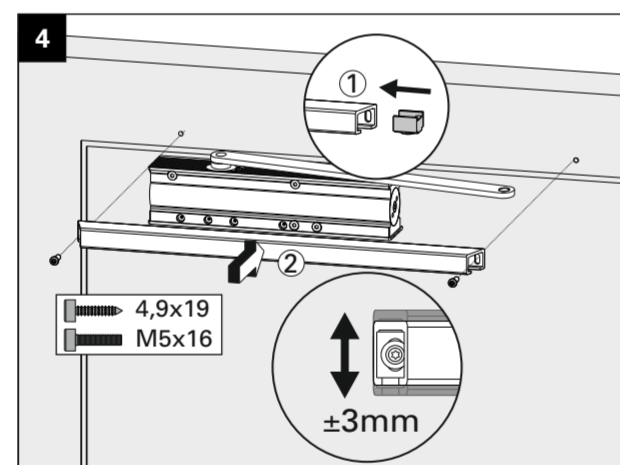
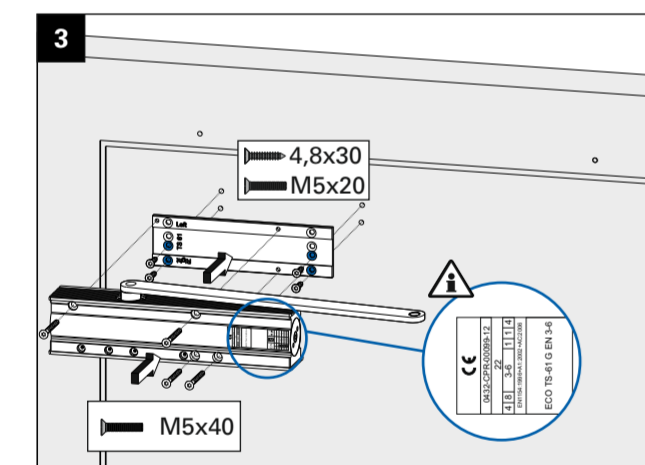
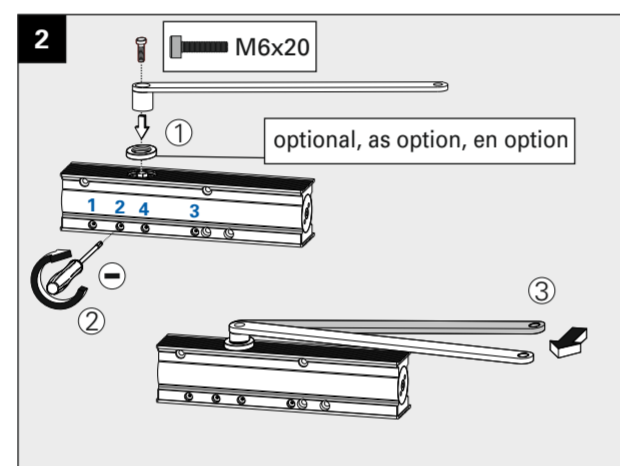
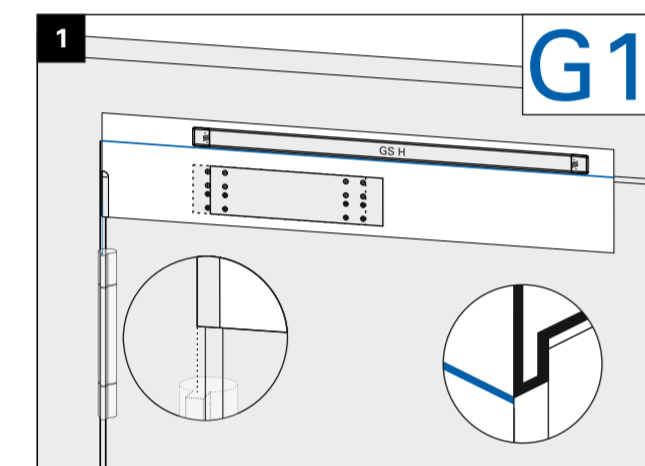

Türschließergröße Door closer size Force de ferme porte	Max. Türbreite Max. door width Largeur de porte max.	Umdrehungen Rotations Rotations
■3 F	950 mm	0
■4 F	1100 mm	+4
■5 F	1250 mm	+10
■6 F	1400 mm	+17

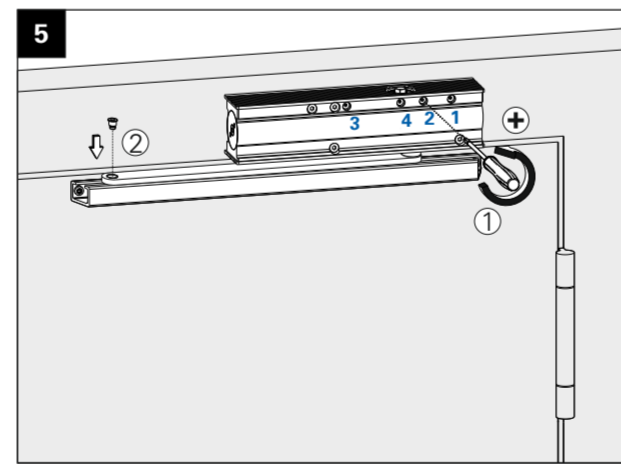
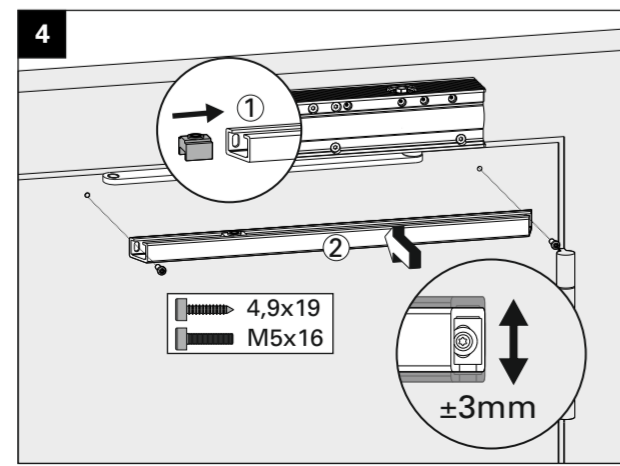
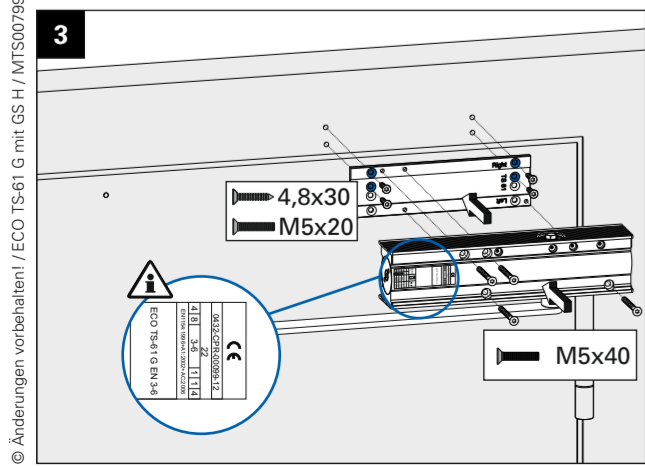
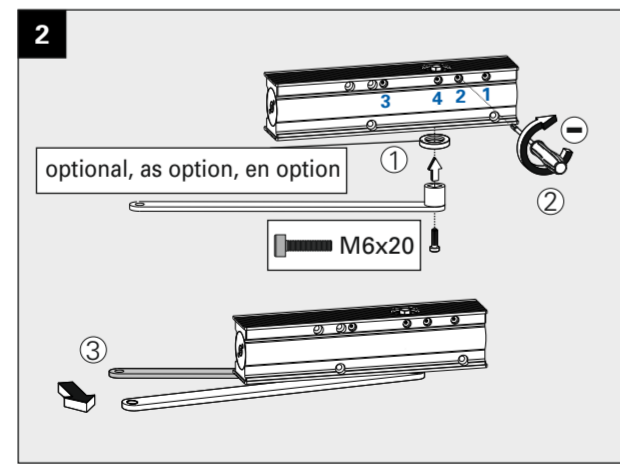
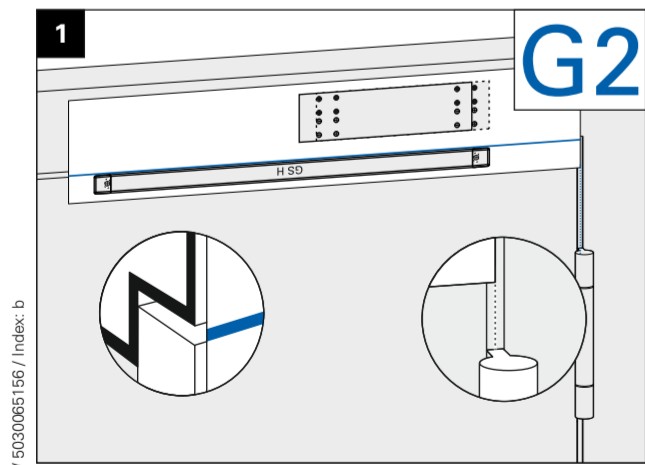
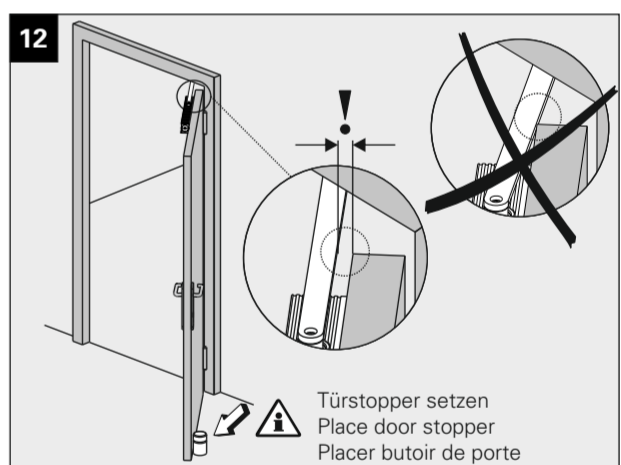
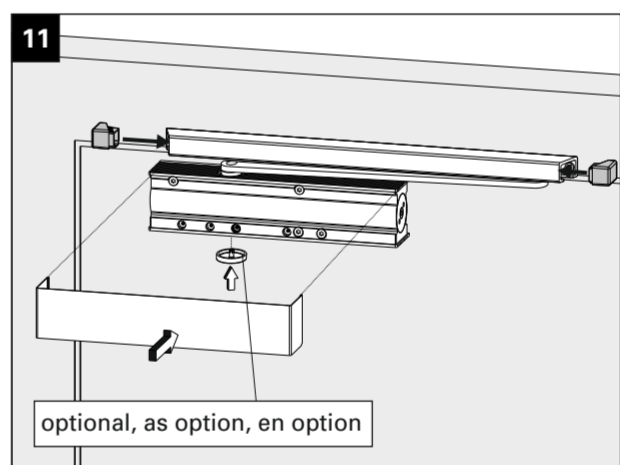
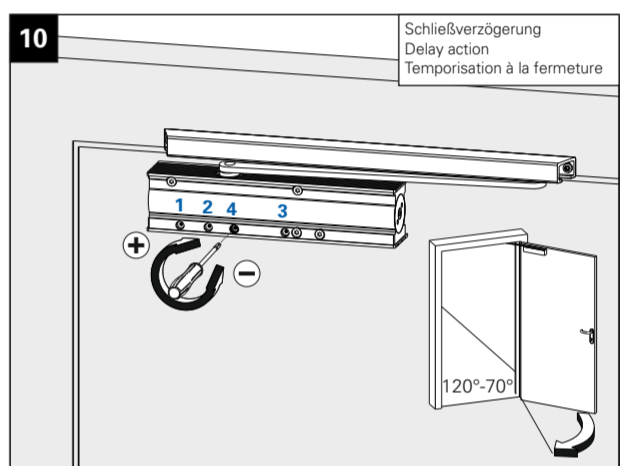
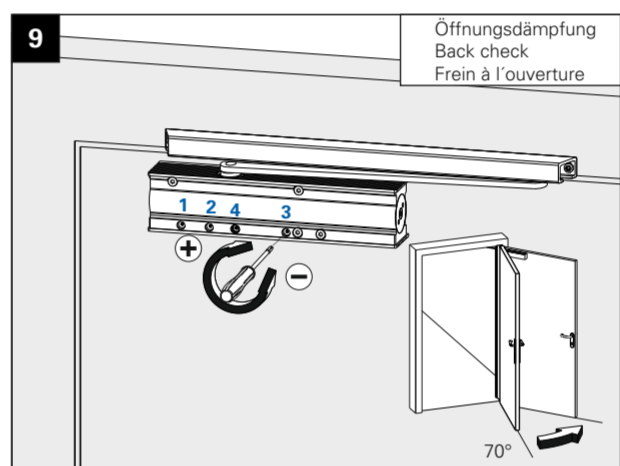
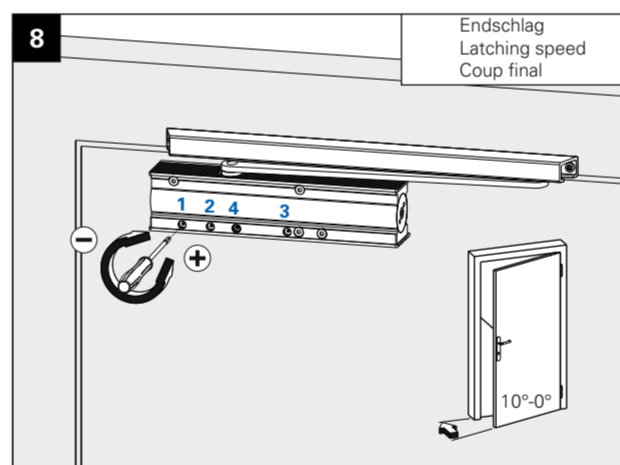
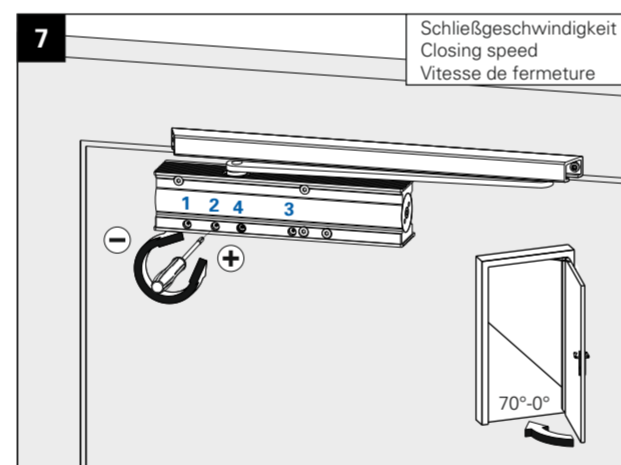

Türschließergröße Door closer size Force de ferme porte	Max. Türbreite Max. door width Largeur de porte max.	Umdrehungen Rotations Rotations
■3 F	950 mm	0
■4 F	1100 mm	+4
■5 F	1250 mm	+10
■6 F	1400 mm	+17

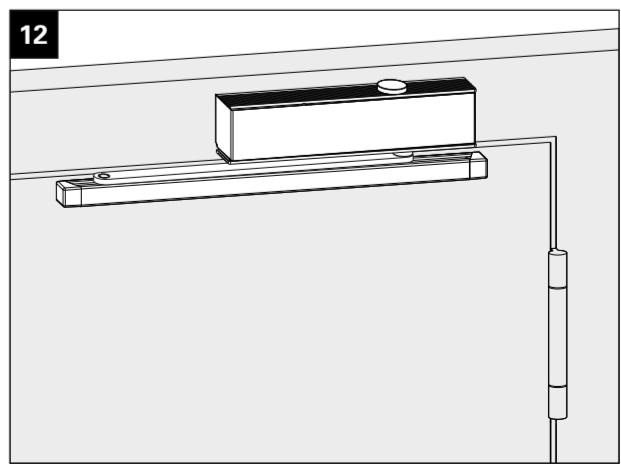
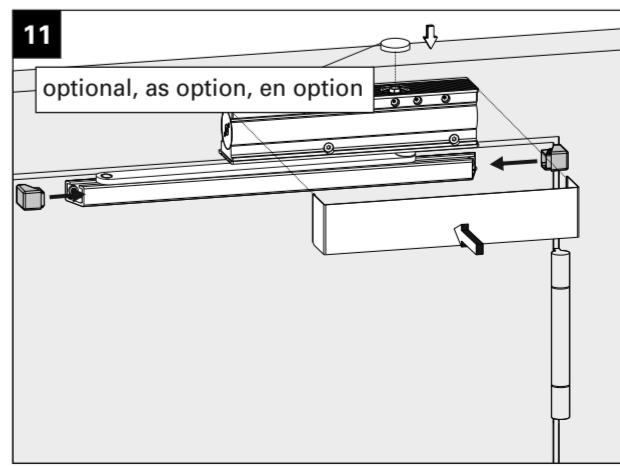
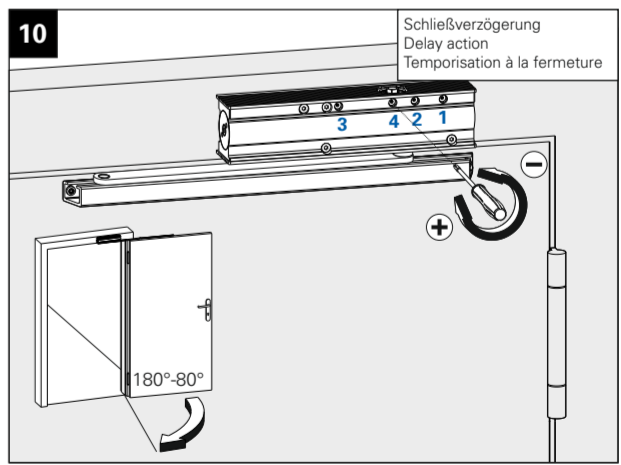
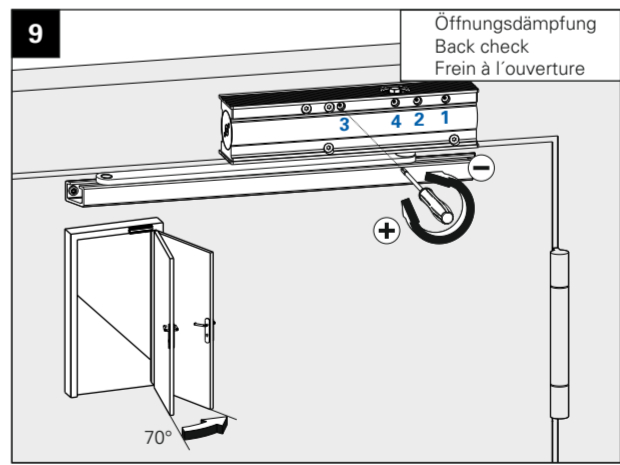
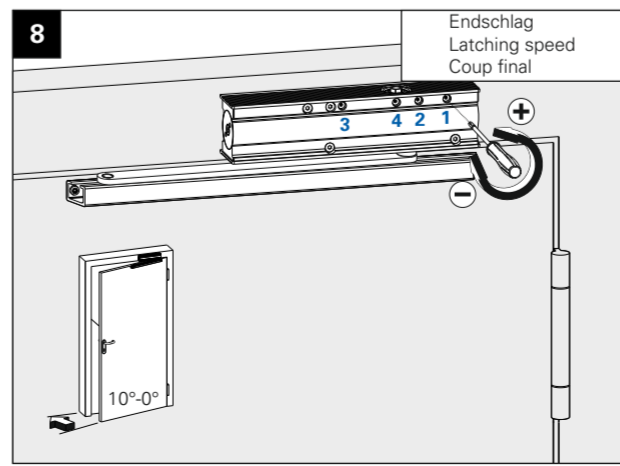
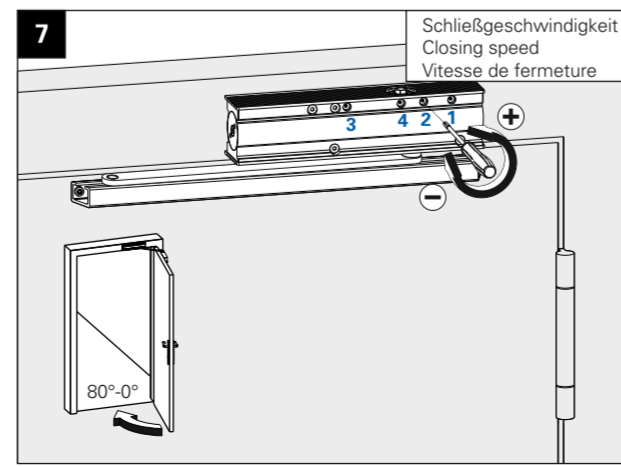

GS-H

428,5
428,5

Ø 2,5
Ø 4,2 (M5)

G3 (X 80 - 95) = 130
G3 (X < 80) = 120 / G4 = 120

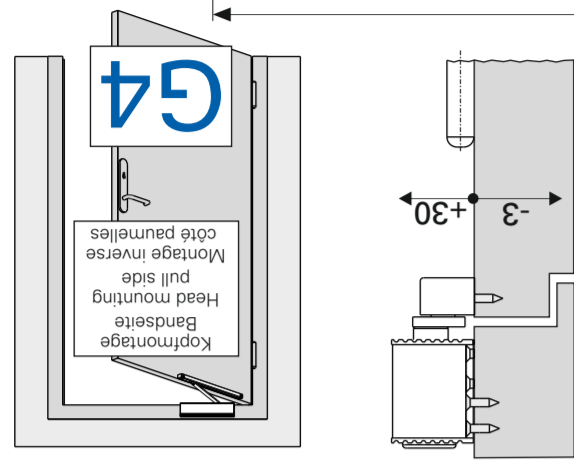

DIN links / left / gauche

- Lochgruppe für Normalmontage Bandgegenseite
Drillings for standard mounting push side
Alésage pour montage normal côté opposé paumelles
- Lochgruppe für Kopfmontage Bandseite
Drillings for head mounting pull side
Alésage pour montage inversé côté paumelles

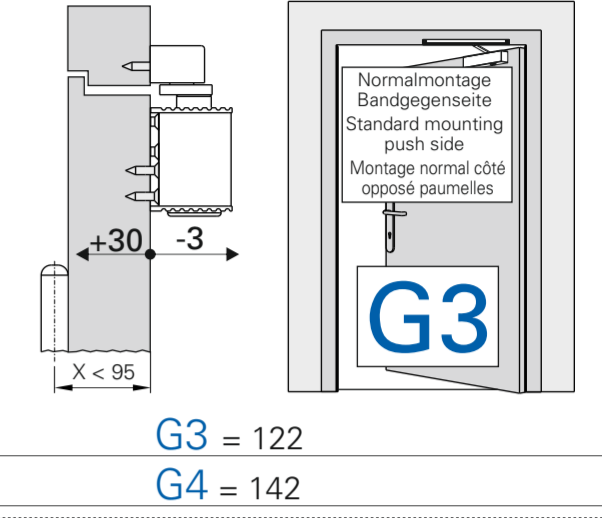
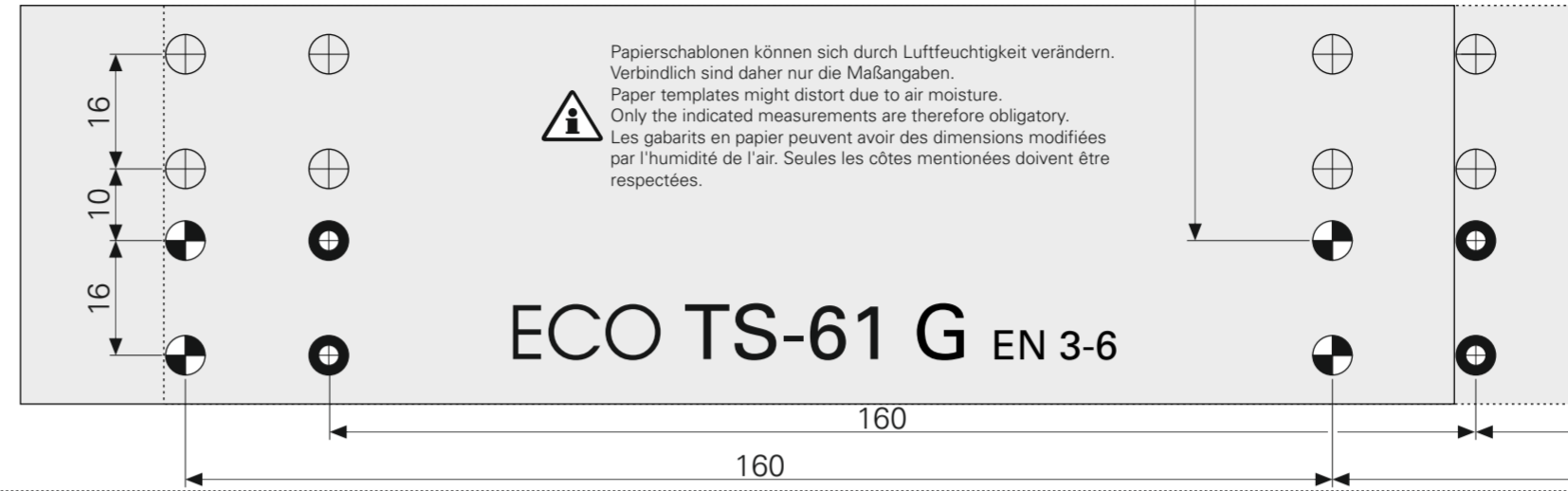

ECO TS-61 G EN 3-6

CE	ECO Schulte GmbH & Co. KG Iserlohner Landstraße 89 D-58706 Menden	22
0432-CPR-00099-12	EN 1154:1996+A1:2002 / AC:2006	4 8 3-6 1 1 4

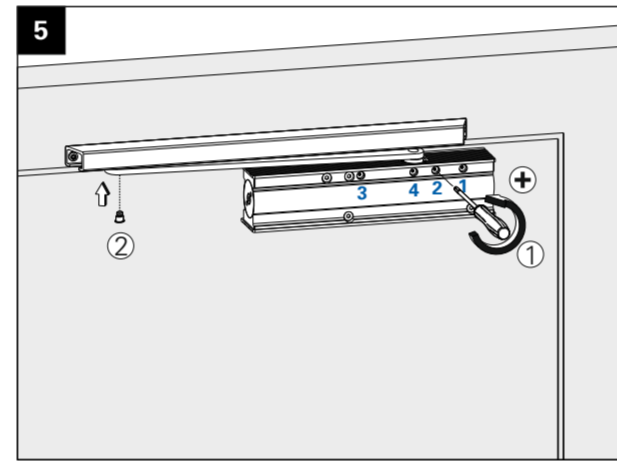
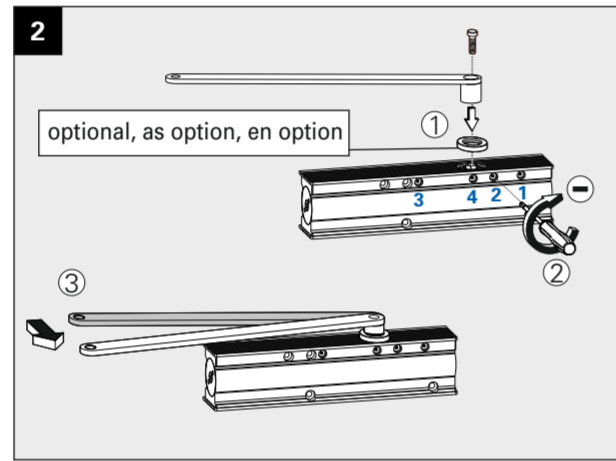
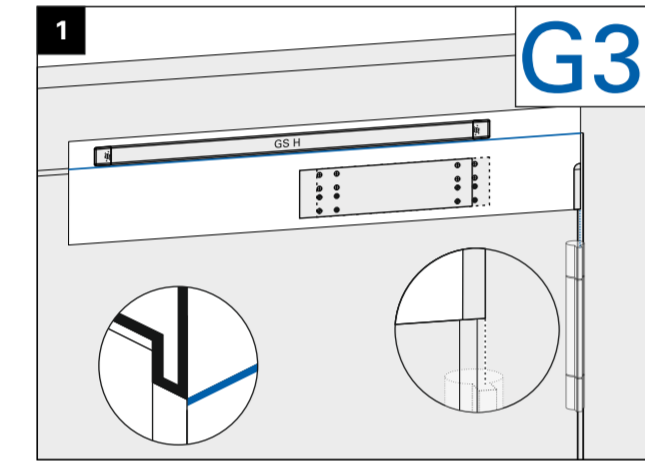

Schließkraft
Closing force
Force de fermeture

Türschließergröße Door closer size Force de ferme porte	Max. Türbreite Max. door width Largeur de porte max.	Umdrehungen Rotations Rotations
■ 3 F	950 mm	0
■ 4 F	1100 mm	+4
■ 5 F	1250 mm	+10
■ 6 F	1400 mm	+17

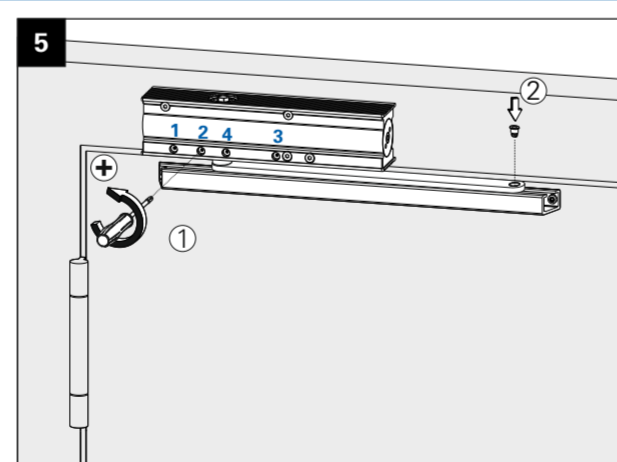
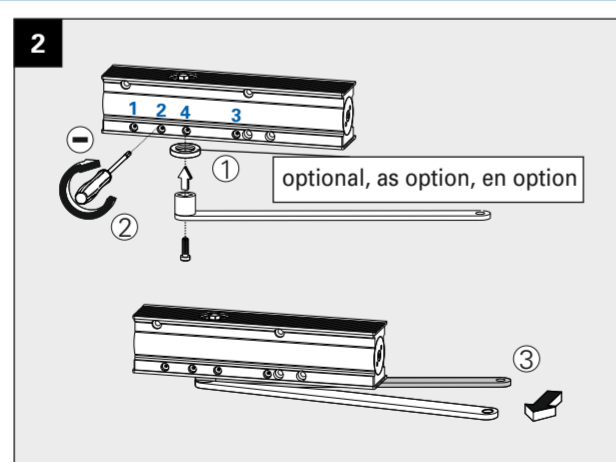
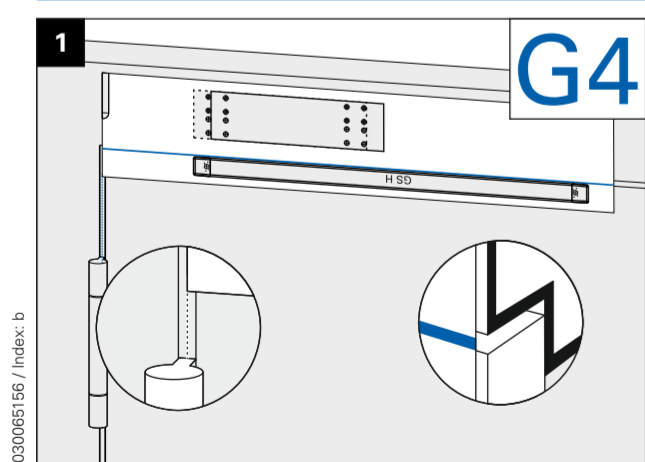
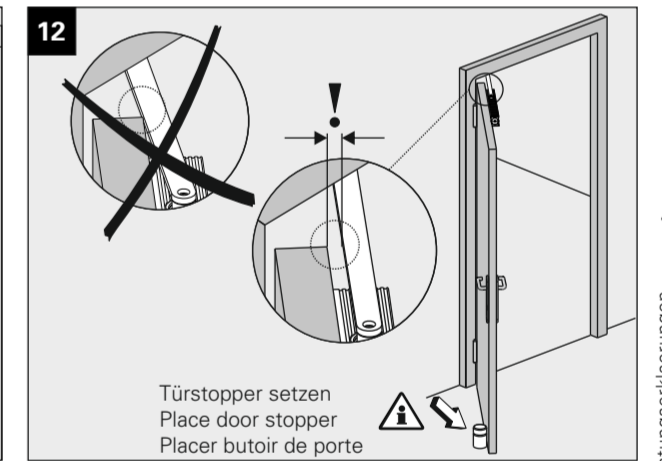
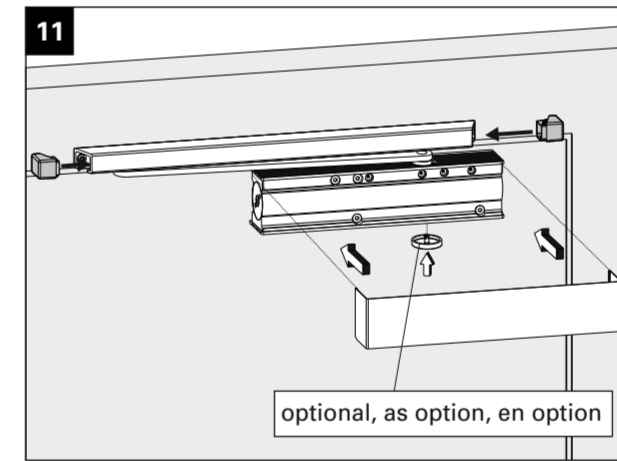
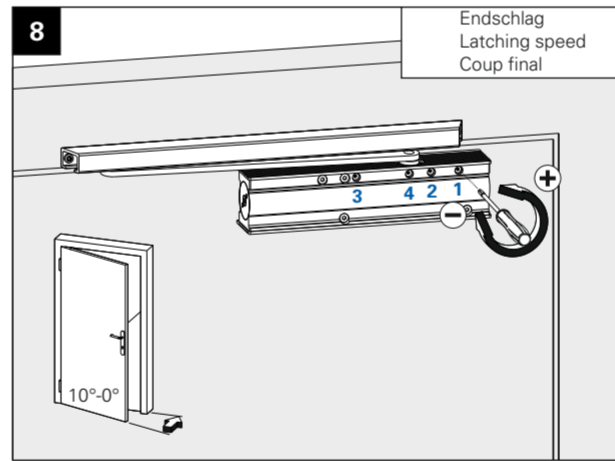
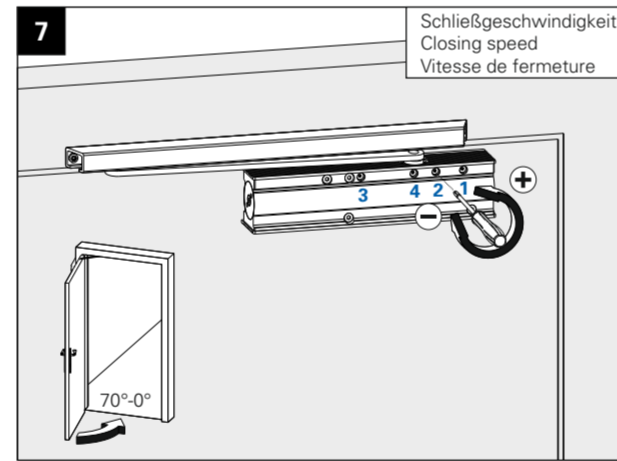
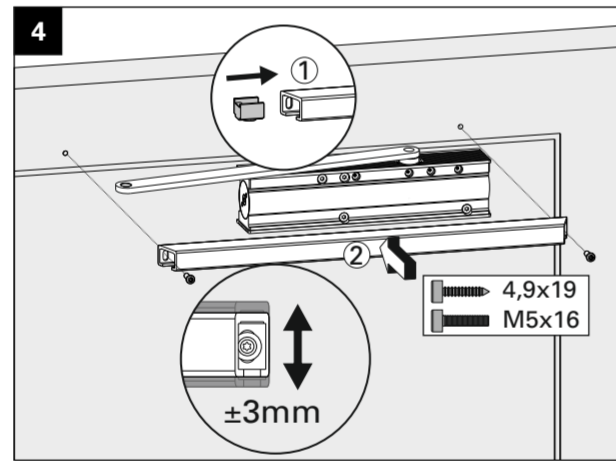
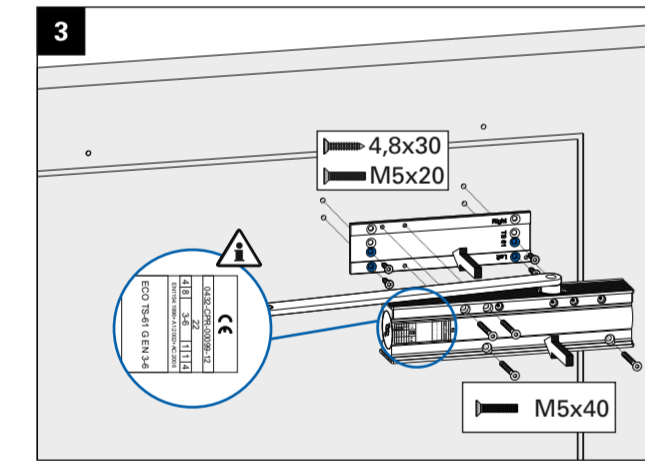
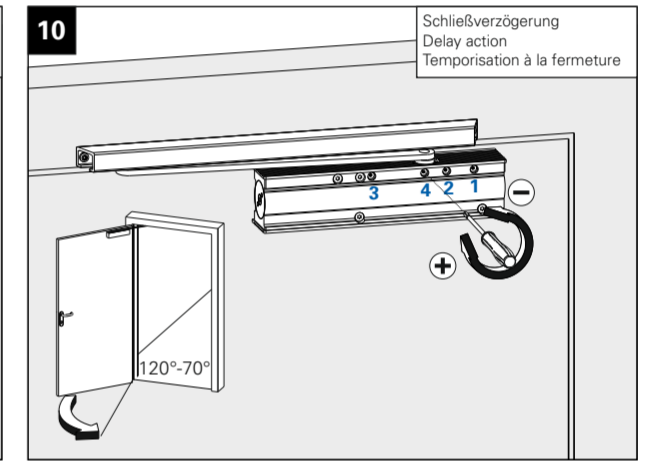
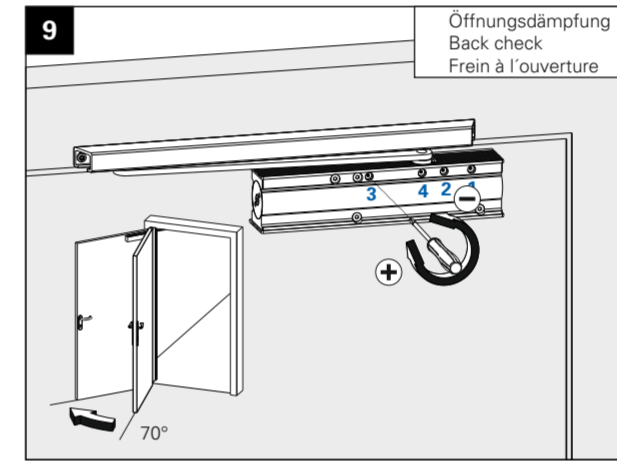

Schließkraft
Closing force
Force de fermeture

Türschließergröße Door closer size Force de ferme porte	Max. Türbreite Max. door width Largeur de porte max.	Umdrehungen Rotations Rotations
■ 3 F	950 mm	0
■ 4 F	1100 mm	+4
■ 5 F	1250 mm	+10
■ 6 F	1400 mm	+17

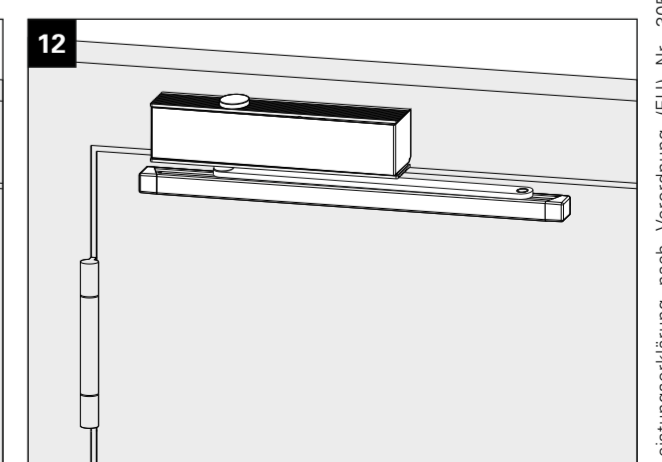
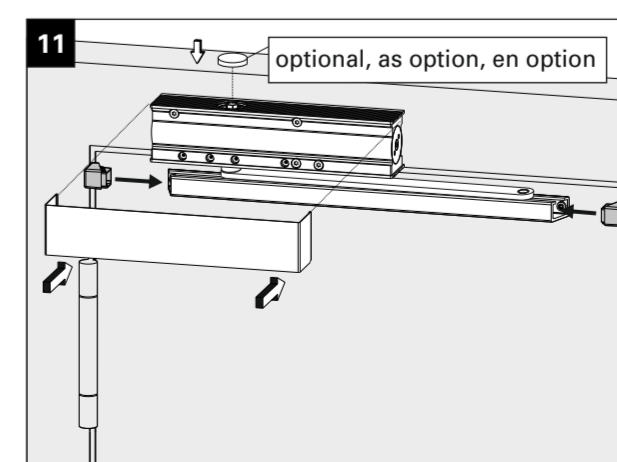
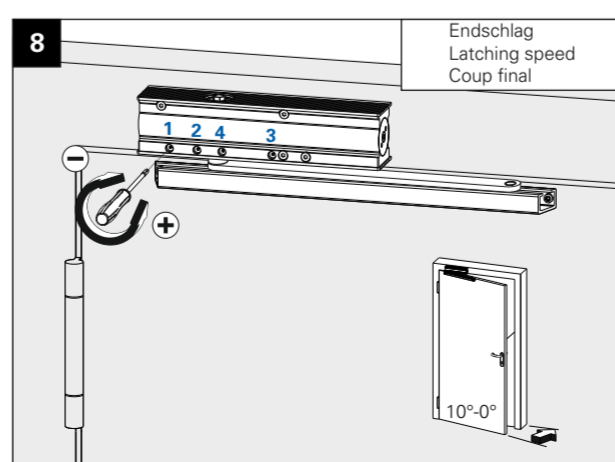
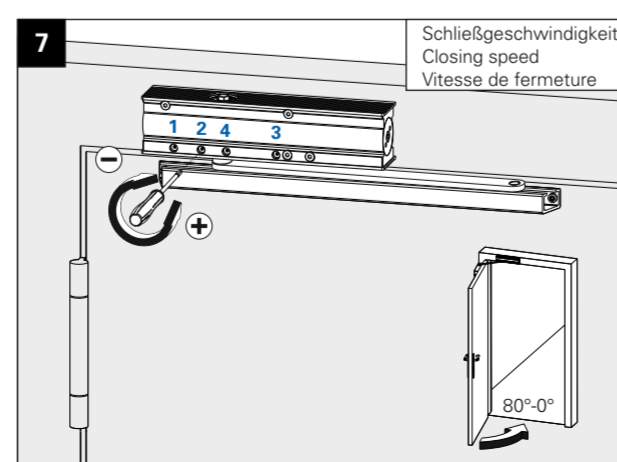
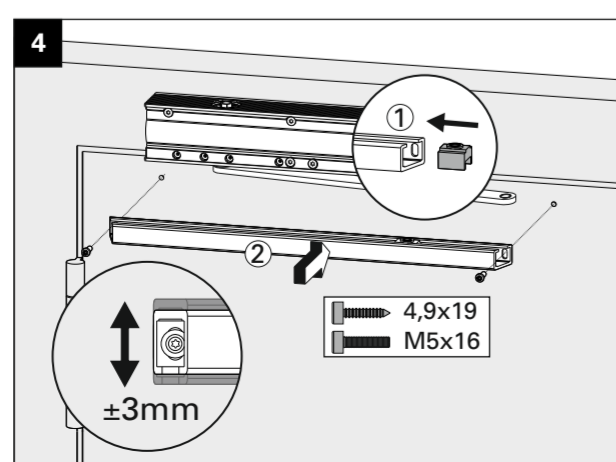
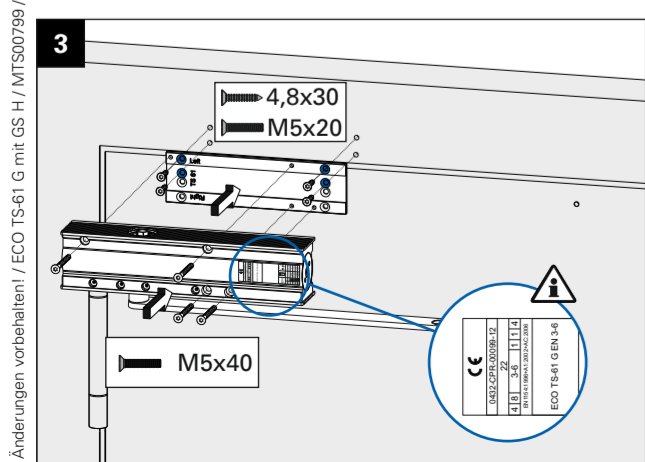
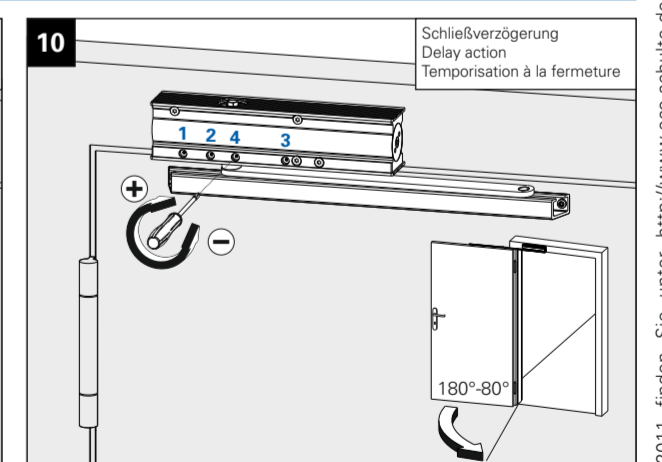
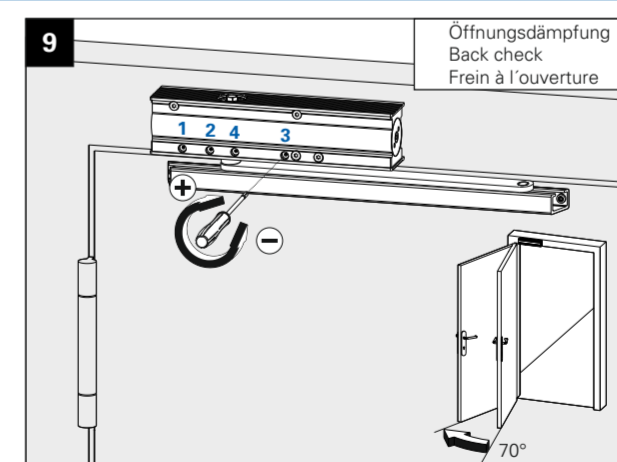

© Änderungen vorbehalten / ECO TS-61 G mit GS H / MTS0798 / 500065156 / Index: b

Je nach Türblattdicke und Türbandtyp kann die Winkelangabe der Schließverzögerung variieren.
Angle indication of delayed action can be different depending on door thickness and type of hinge.
Déclaration des performances conformément au règlement (UE) N° 305/2011 voir <http://www.eco-schulte.de/declarationsperformances>