

GS-H

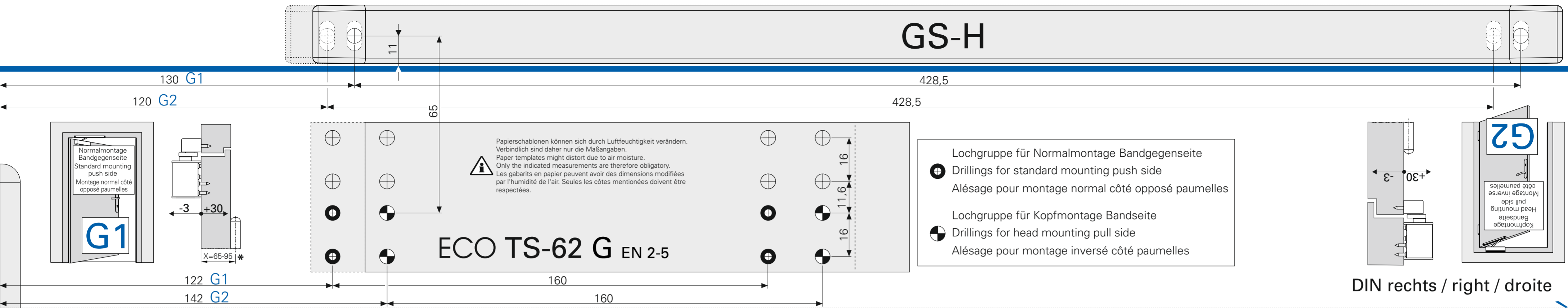

ECO TS-62 G EN 2-5

CE	ECO Schulte GmbH & Co. KG Iserlohner Landstraße 89 D-58706 Menden	15
	0432-CPR-00099-04	EN 1154:1996/A1:2002/ AC:2006

Türschließergröße Door closer size Force de fermette	Max. Türbreite Max. door width Largeur de porte max.	Umdrehungen Rotations Rotations
■2	850 mm	-2
■3	950 mm	0
■4	1100 mm	+6
■5	1250 mm	+11

* bei X-Maß >95 Gleitschiene GS HF + Hebelarm GS HF verwenden. Bohrmaße siehe Bohrschablone MTS01068 (nicht im Lieferumfang enthalten)
for dimension X >95, use sliding rail GS HF and lever arm GS HF. See drilling template MTS01068 for drilling dimensions (sold separately)
Si dimension X >95, utilisez la glissière GS HF et le bras GS HF. Voir gabarit MTS01068 pour les dimensions de perçage (vendu séparément)

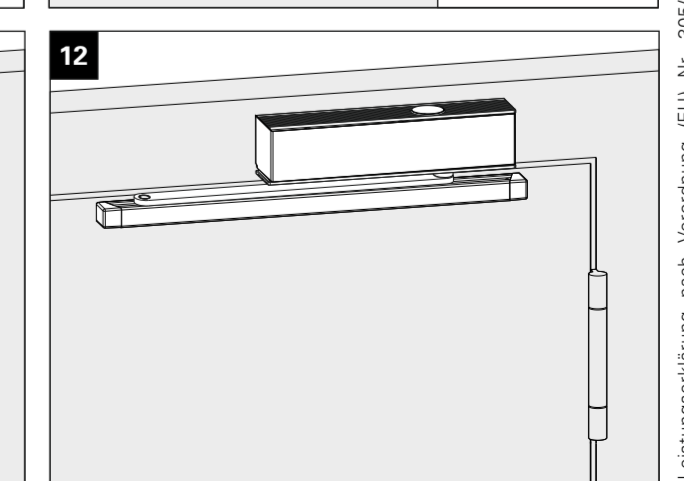
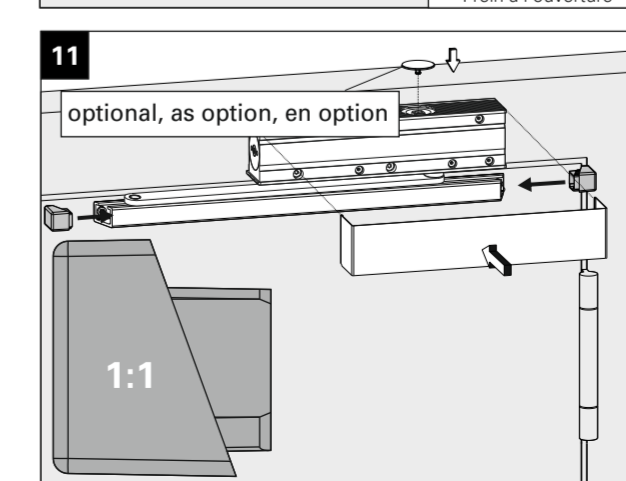
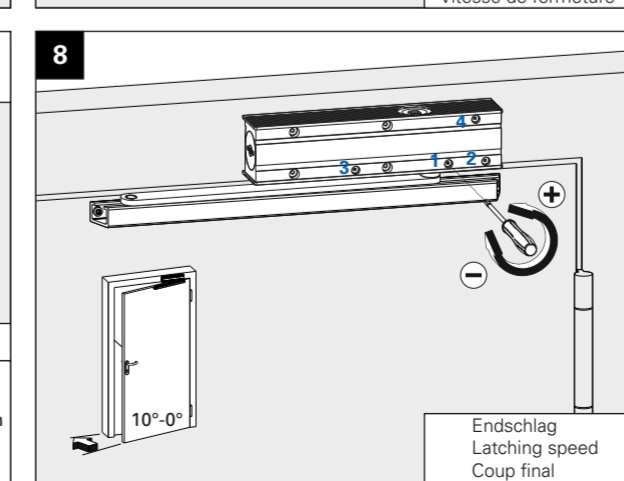
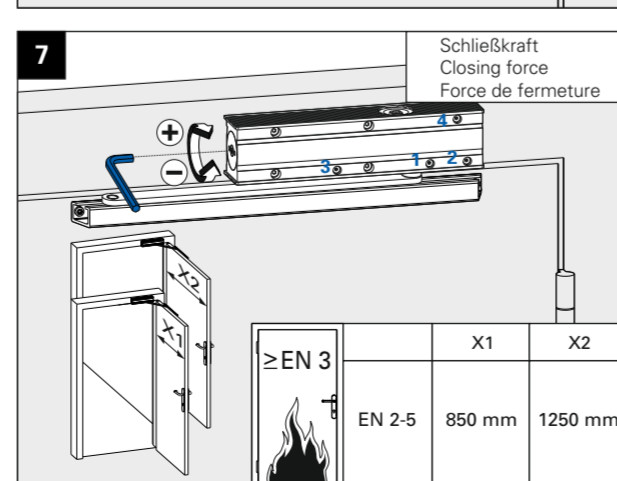
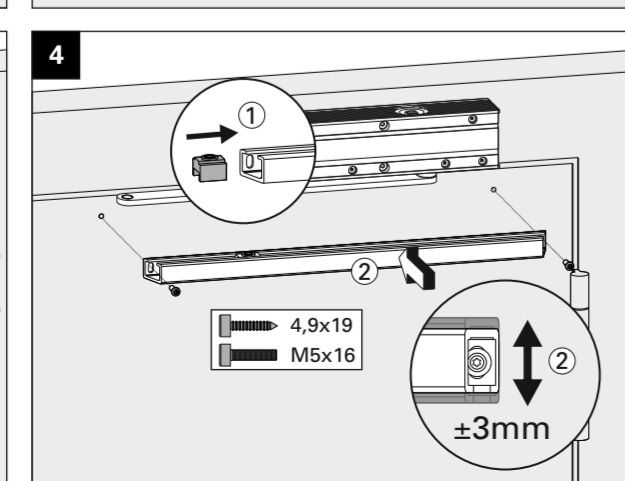
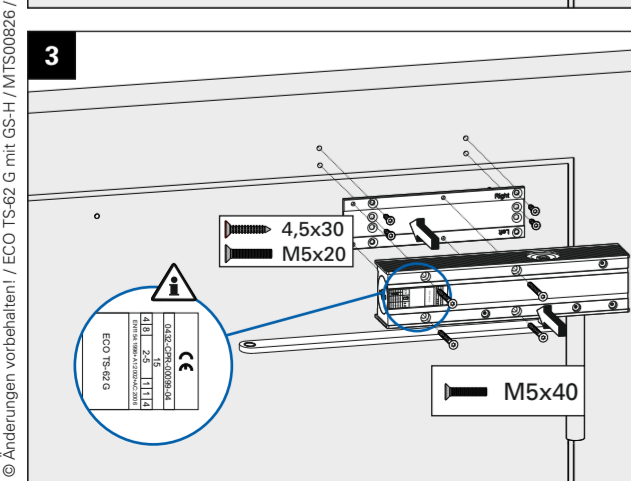
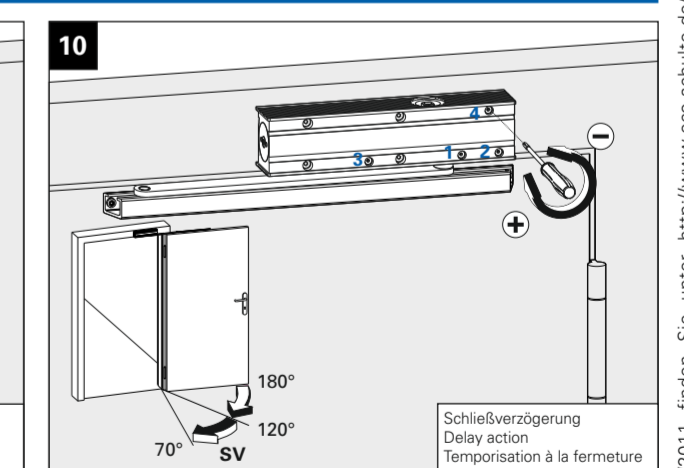
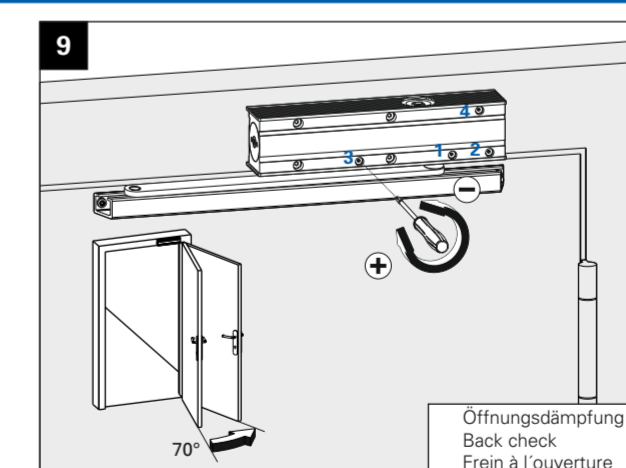
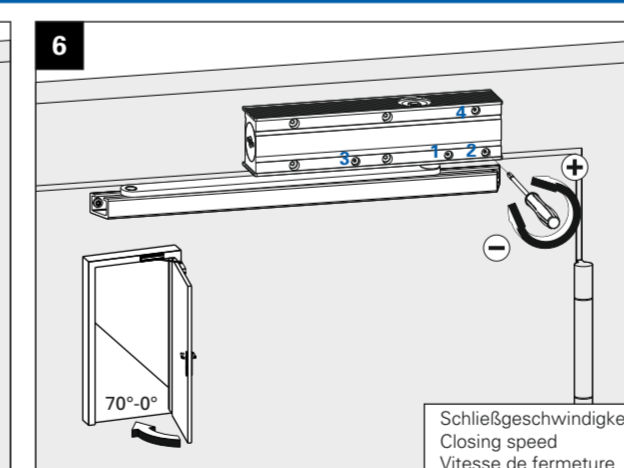
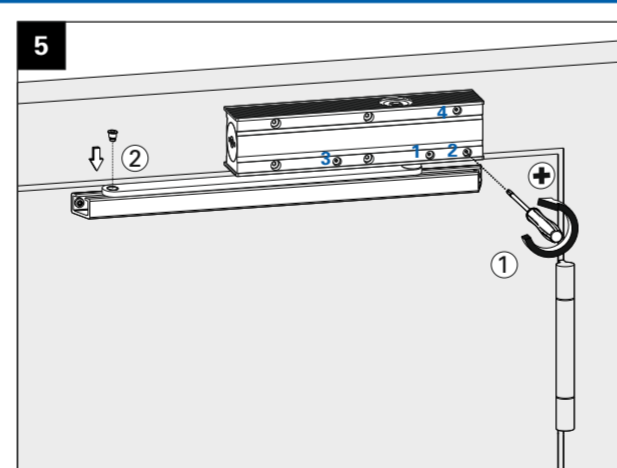
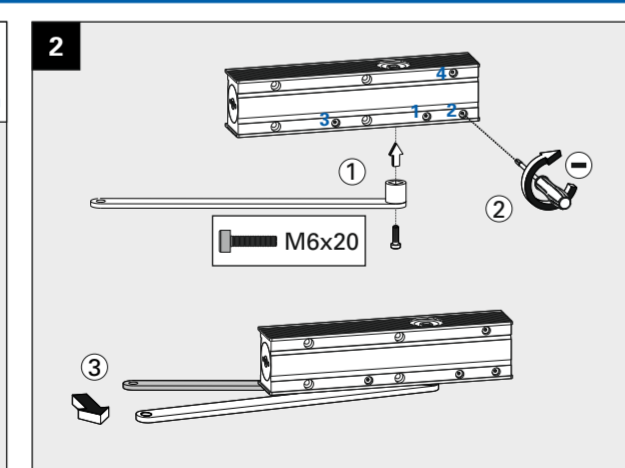
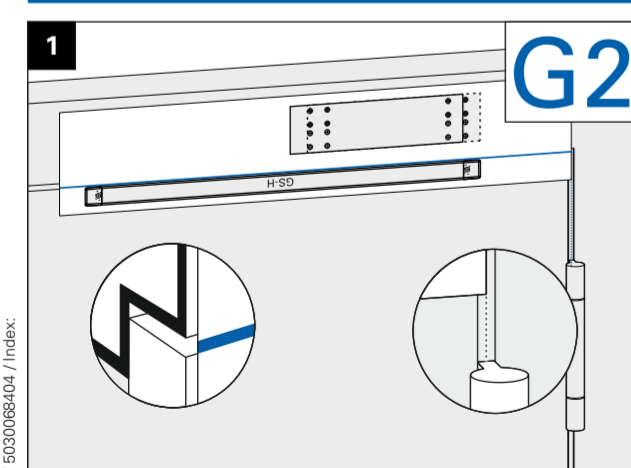
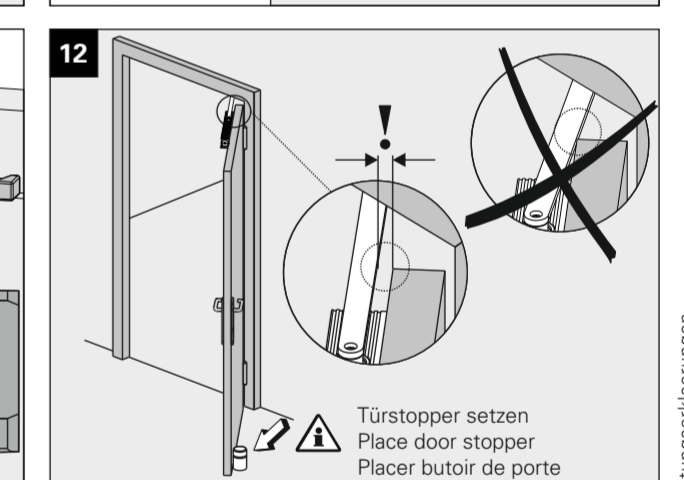
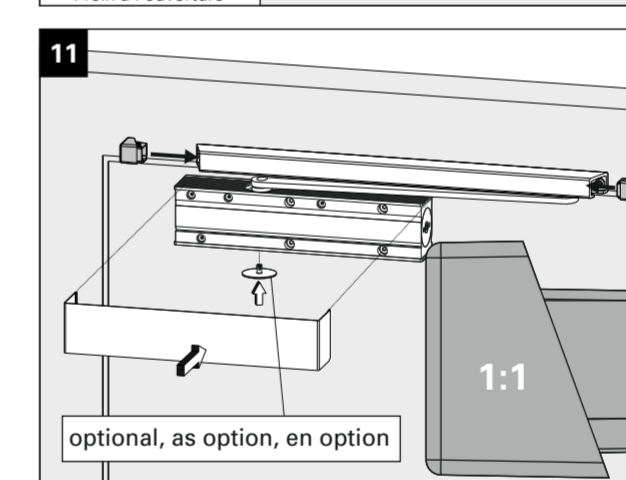
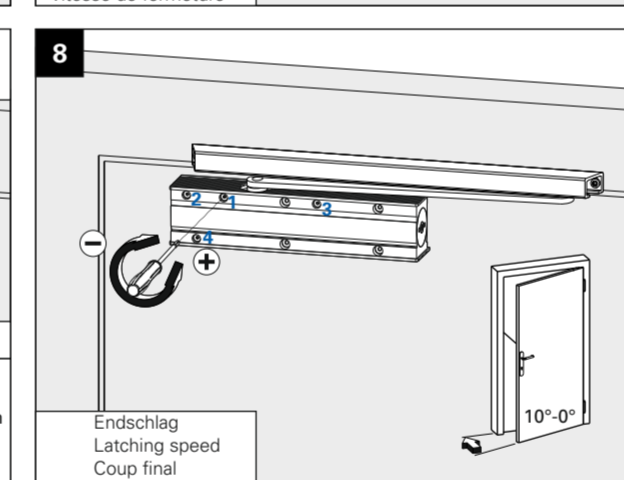
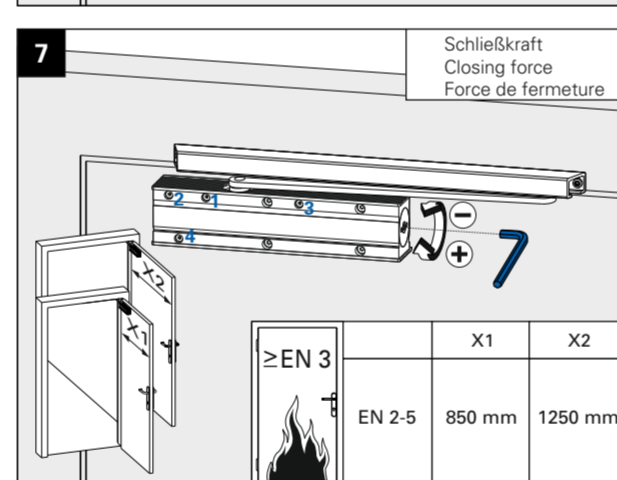
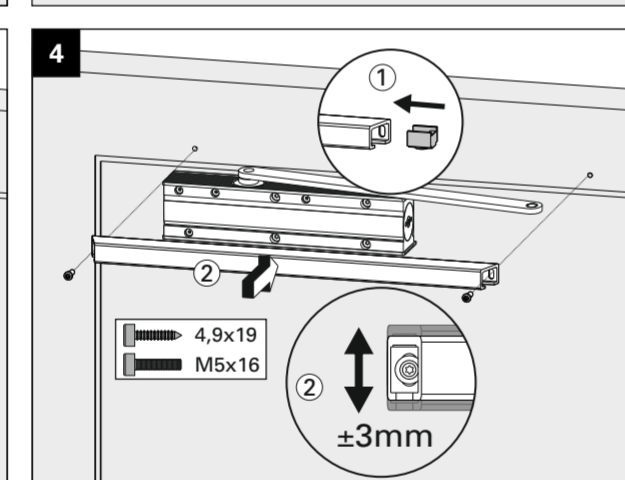
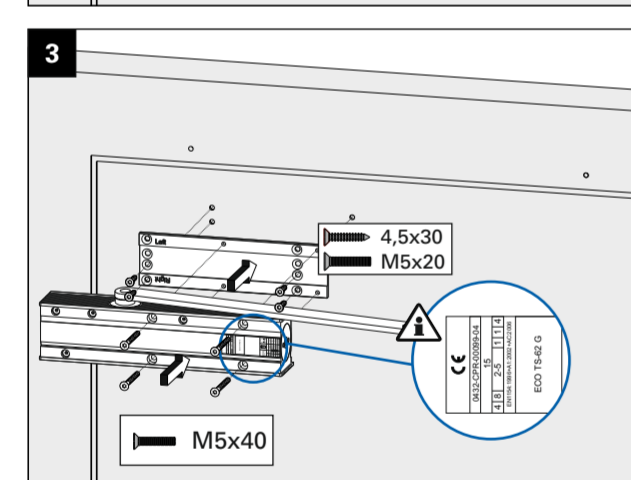
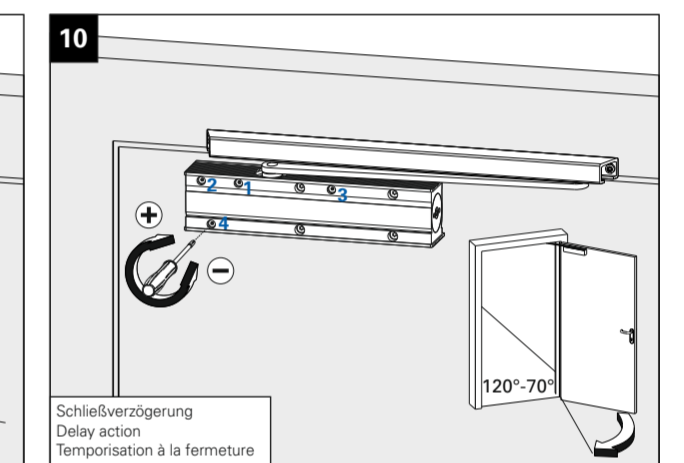
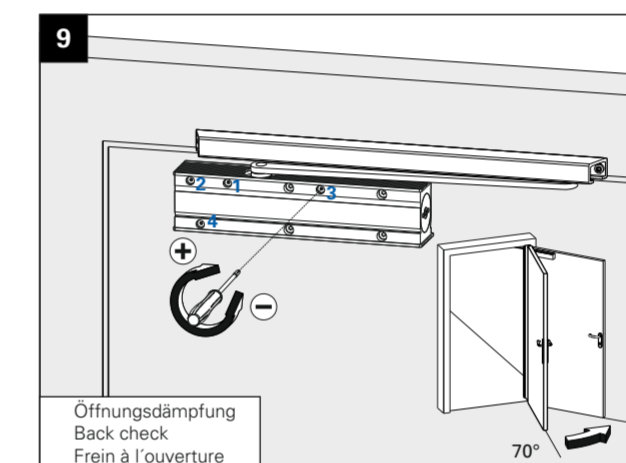
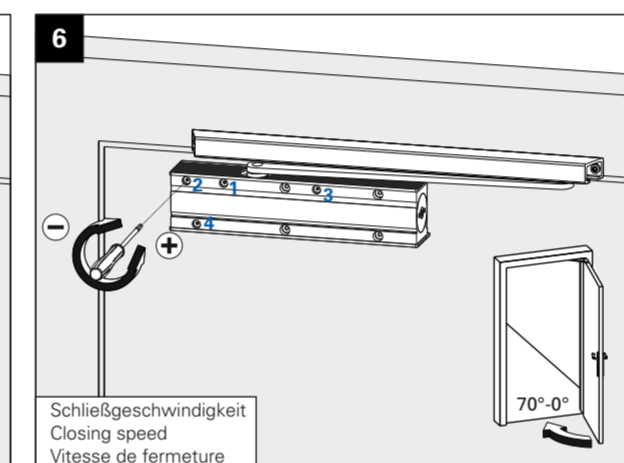
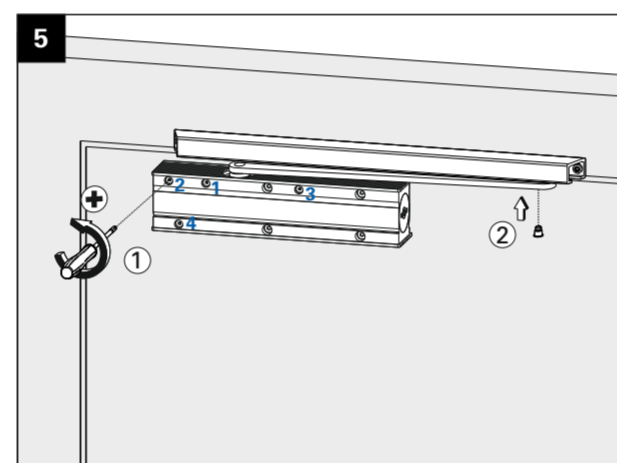
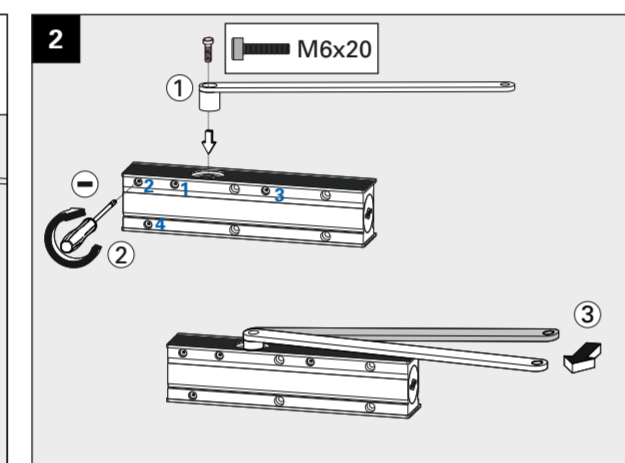
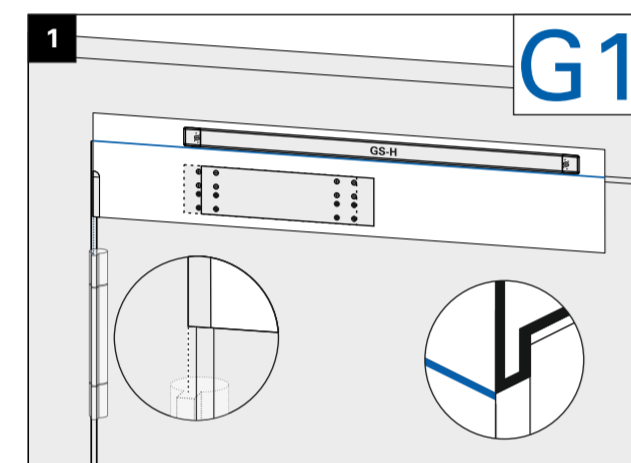

GS-H

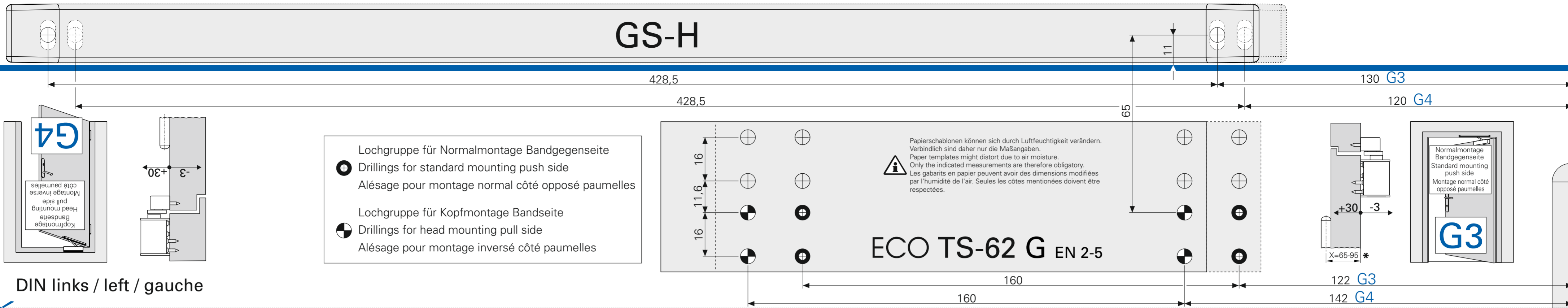

ECO TS-62 G EN 2-5

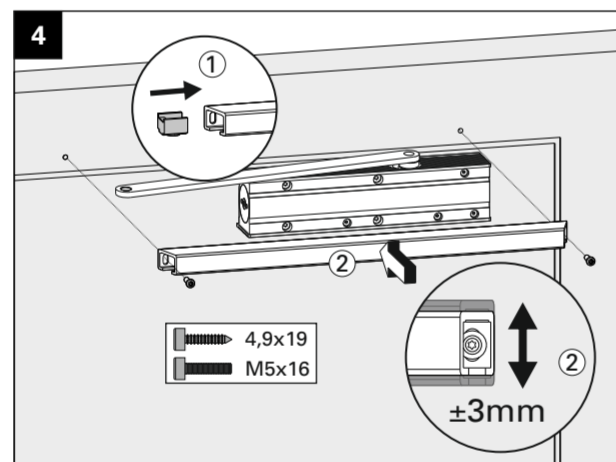
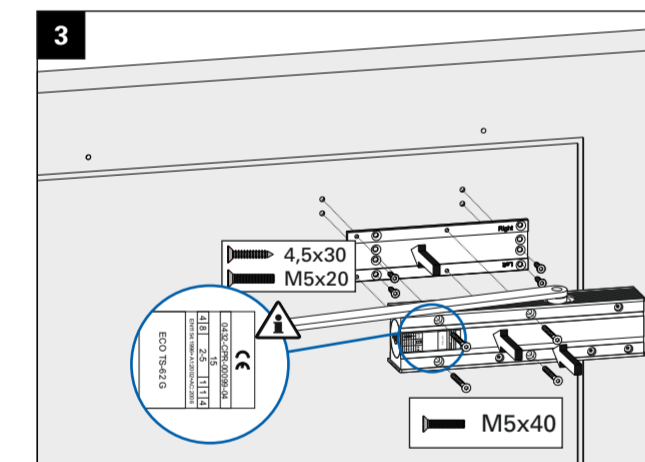
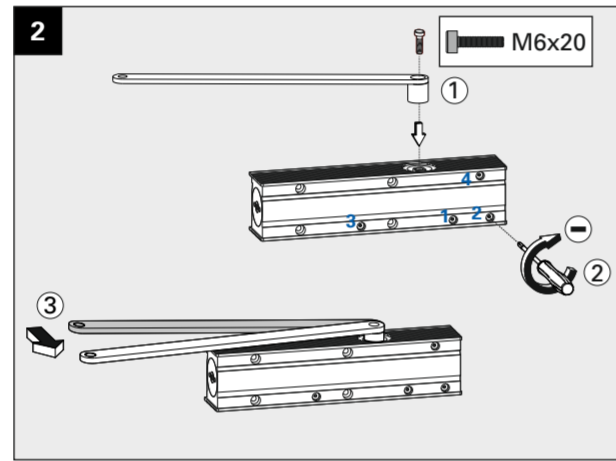
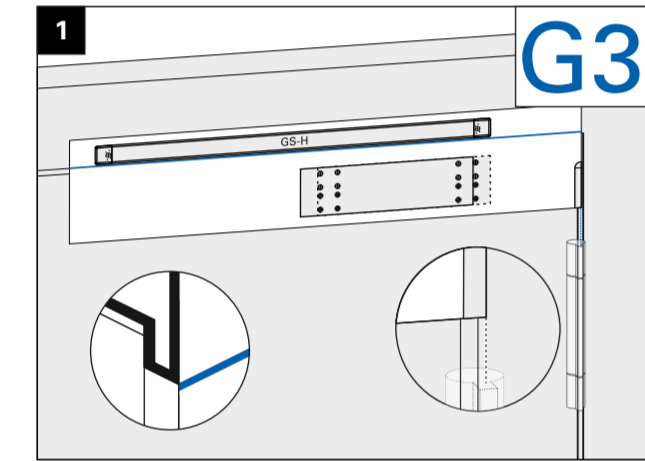

CE	ECO Schulte GmbH & Co. KG Iserlohner Landstraße 89 D-58706 Menden	15				
	0432-CPR-00099-04	EN 1154:1996/A1:2002/ AC:2006				
	4	8	2-5	1	1	4

Türschließergröße Door closer size Force de fermette	Max. Türbreite Max. door width Largeur de porte max.	Umdrehungen Rotations Rotations
■2	850 mm	-2
■3	950 mm	0
■4	1100 mm	+6
■5	1250 mm	+11

ECO TS-62 G EN 2-5

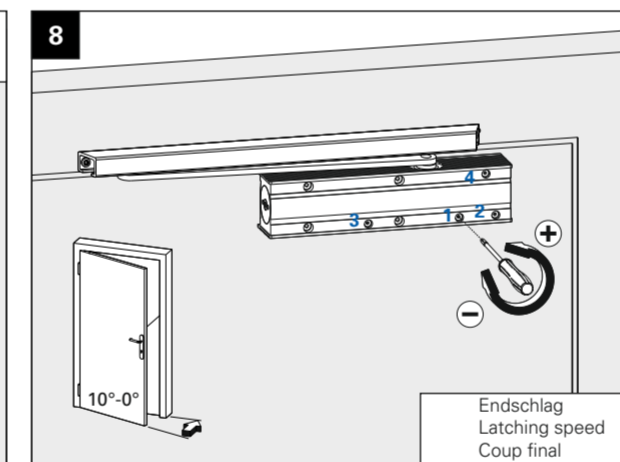
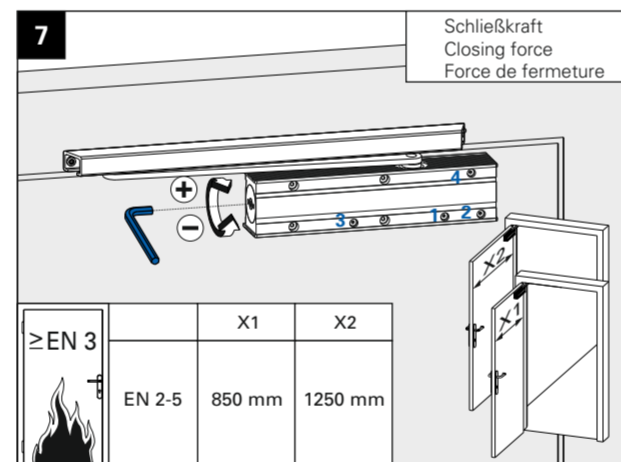
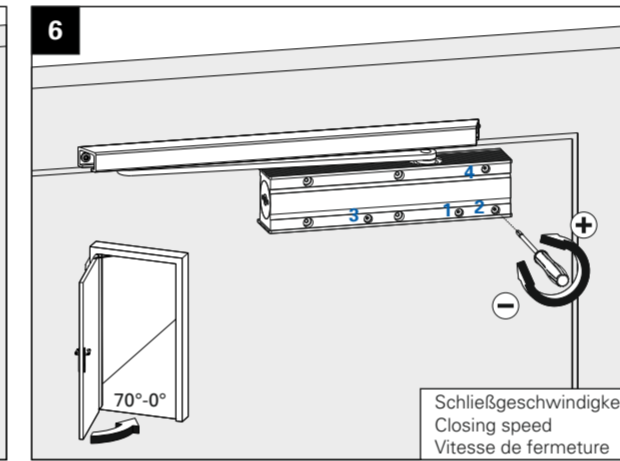
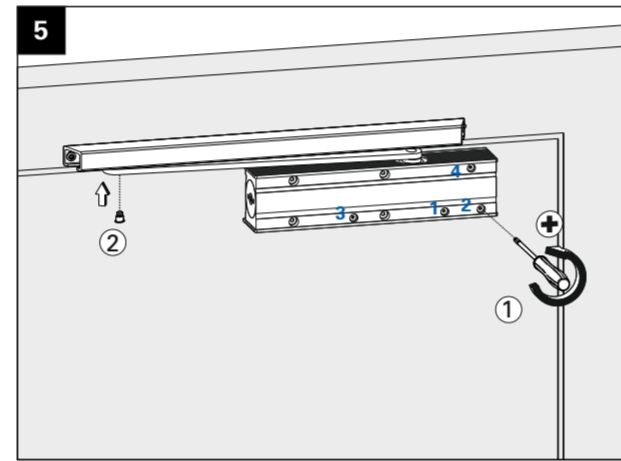

* bei X-Maß >95 Gleitschiene GS HF + Hebelarm GS HF verwenden. Bohrmaße siehe Bohrschablone MTS01068 (nicht im Lieferumfang enthalten) for dimension X >95, use sliding rail GS HF and lever arm GS HF. See drilling template MTS01068 for drilling dimensions (sold separately) Si dimension X >95, utilisez la glissière GS HF et le bras GS HF. Voir gabarit MTS01068 pour les dimensions de perçage (vendu séparément)

