

Montageanleitung / Assembly instruction / Notice de montage



ECO

Parallelarm / Parallel arm / Bras parallèle mit / with / avec **TS-50/20 (RFG)**

DIN links / left / gauche
 DIN rechts (spiegelbildlich)
 DIN right (mirror image)
 DIN droite (image inversée)

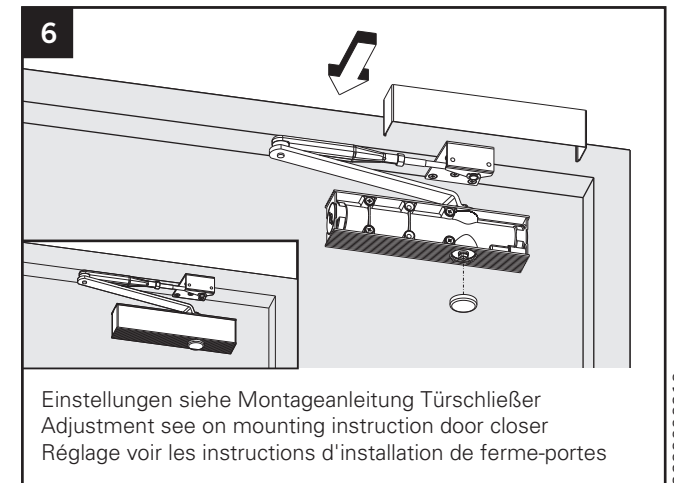
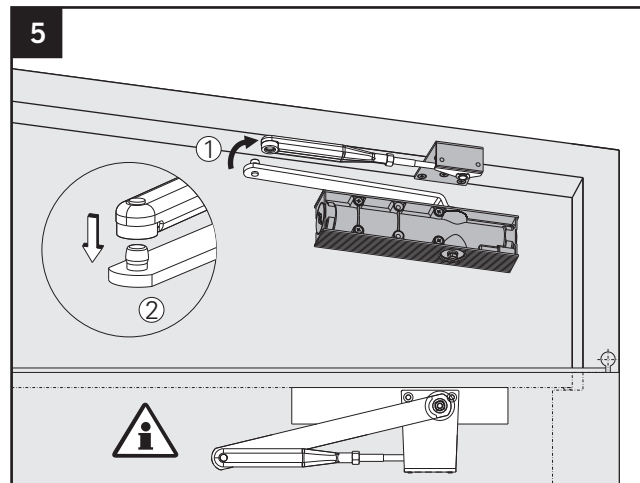
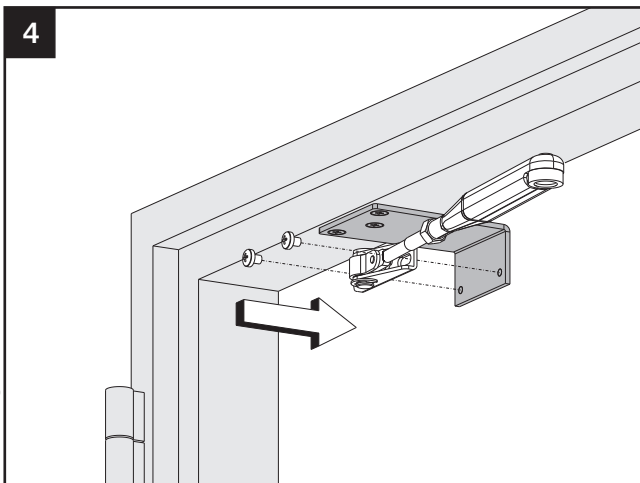
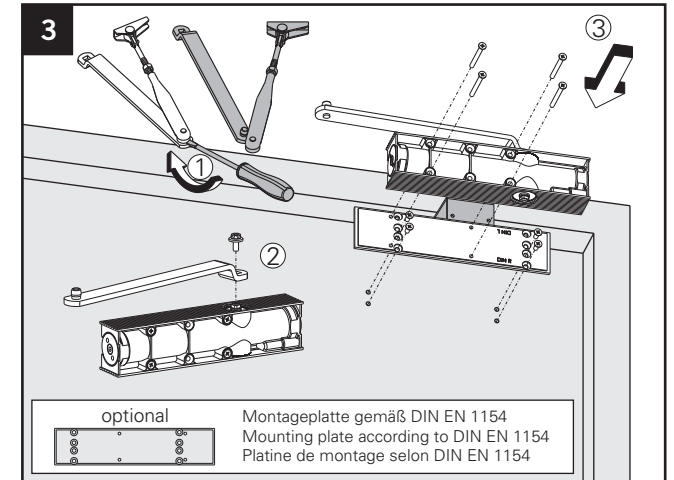
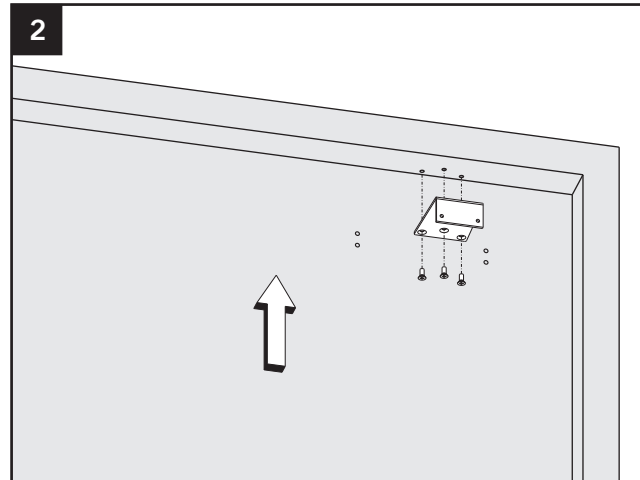
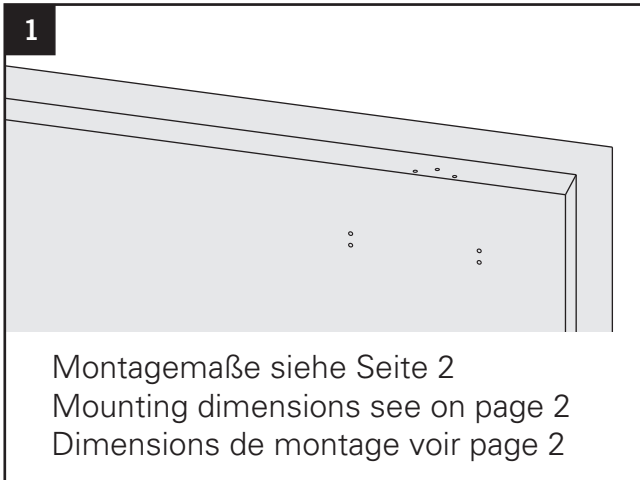

© Änderungen vorbehalten / MTS0033Z / Index: a

3392002319

Montageanleitung / Assembly instruction / Notice de montage



ECO

Parallelarm / Parallel arm / Bras parallèle mit / with / avec **TS-50/20 (RFG)**

DIN links / left / gauche
DIN rechts (spiegelbildlich)
DIN right (mirror image)
DIN droite (image inversée)

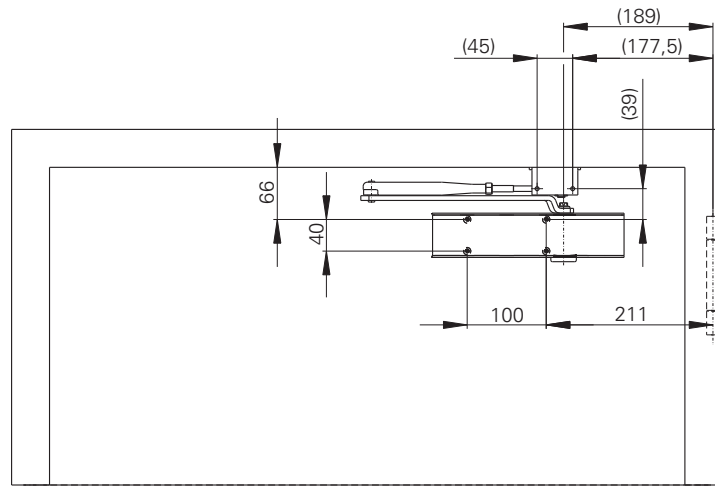
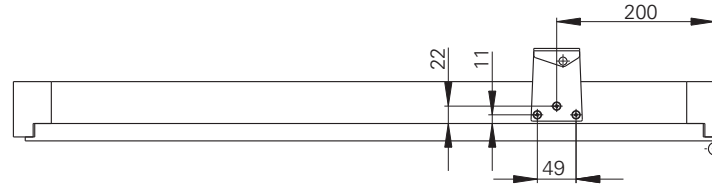

ohne Montageplatte / without mounting plate / sans plaque de montage

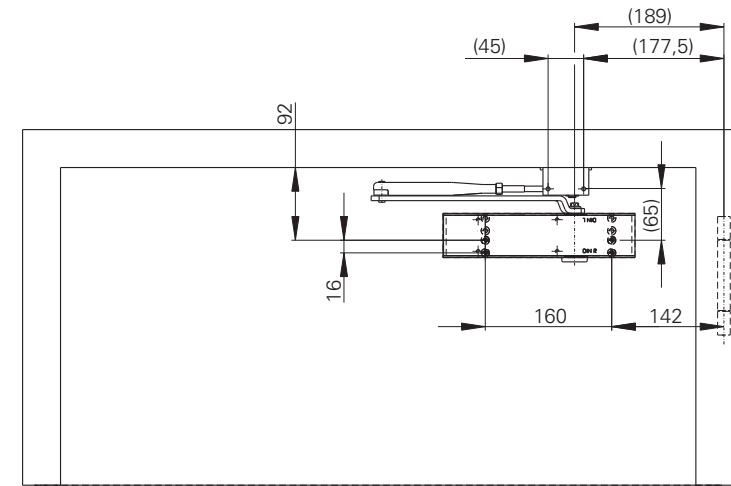

mit Montageplatte / with mounting plate / avec plaque de montage

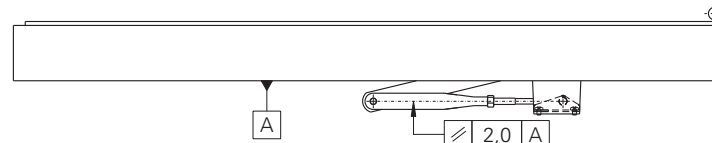

Leistungserklärung nach Verordnung (EU) Nr. 305/2011 finden Sie unter <http://www.eco-schulte.de/leistungserklaerungen>
Declaration of performance according to Regulation (EU) No 305/2011 see <http://www.eco-schulte.de/declarationofperformance>
Déclaration des performances conformément au règlement (UE) N° 305/2011 voir <http://www.eco-schulte.de/declarationdesperformances>

© Änderungen vorbehalten / MTS00332 / Index: a

3392002319