

Bedienungsanweisung ECO ITS-630 (3-6)

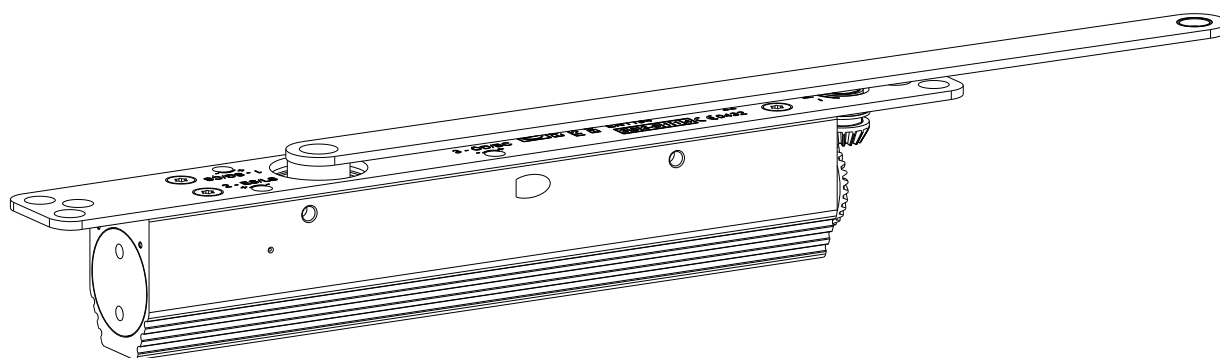

ECO Schulte GmbH & Co. KG

📍 Iserlohner Landstraße 89 - 58706 Menden
☎ +49 2373 9276-0
✉ info@eco-schulte.de



Wichtig: Vor Nutzung gründlich lesen. Aufbewahren für späteres Nachschlagen.

ITS-630 (3-6)

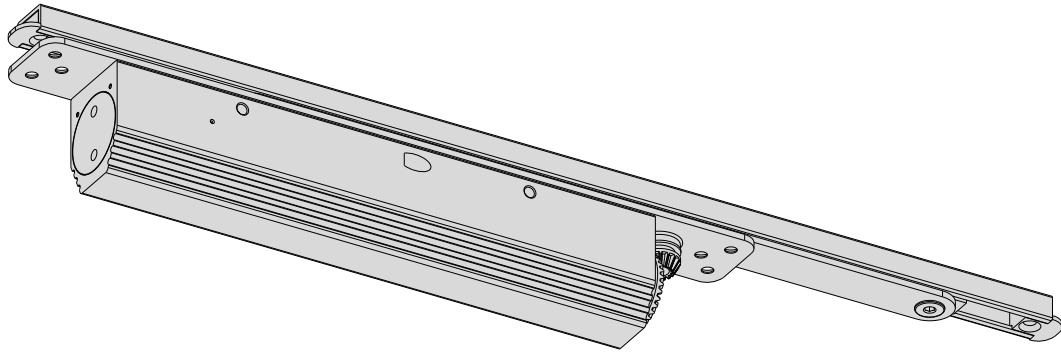

2,5/4/5



TX 25

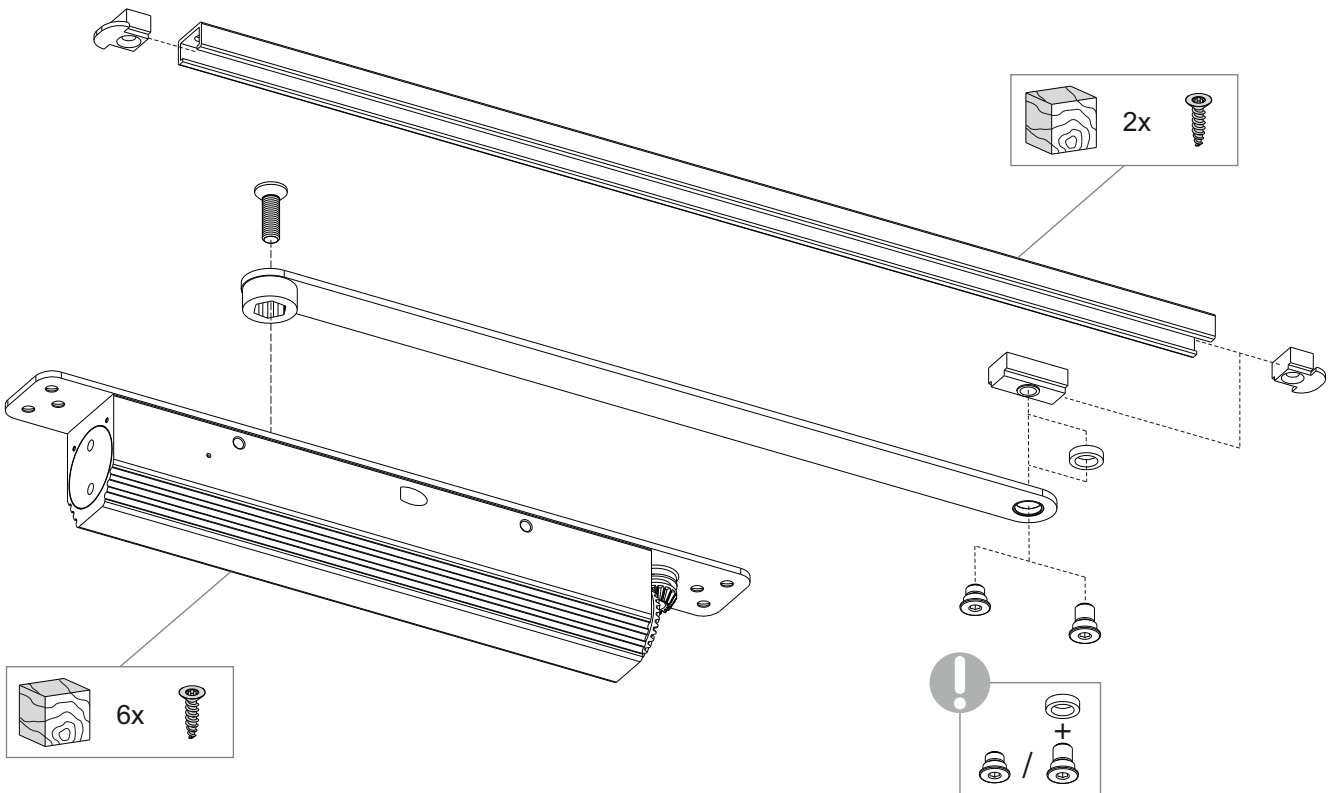

ITS-630 (3-6)



K
8,5
12
12,5
16

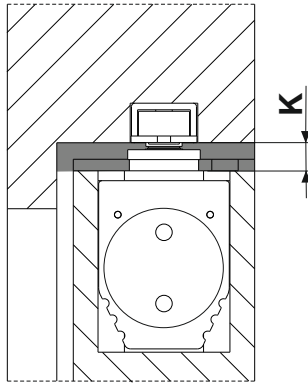

K8,5

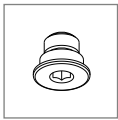

K=8,5-12

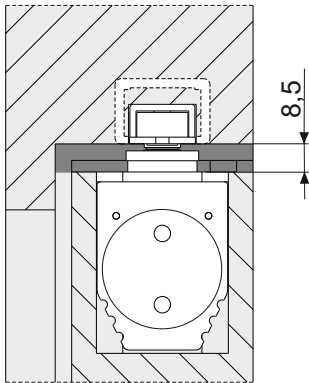

K12

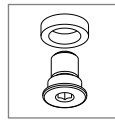
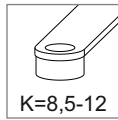

K=8,5-12

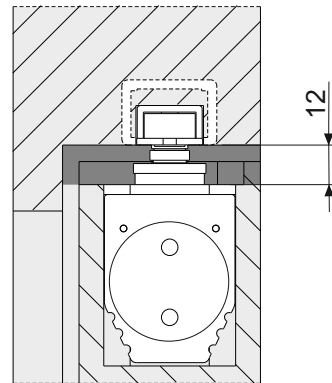

K12,5



K=12,5-16

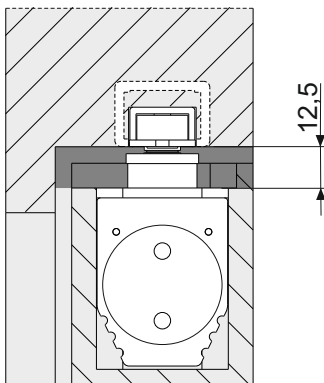

K16

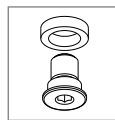
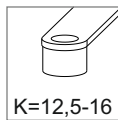

K=12,5-16

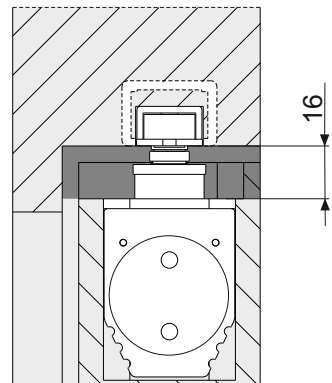

ITS-630 (3-6)

1

2,5

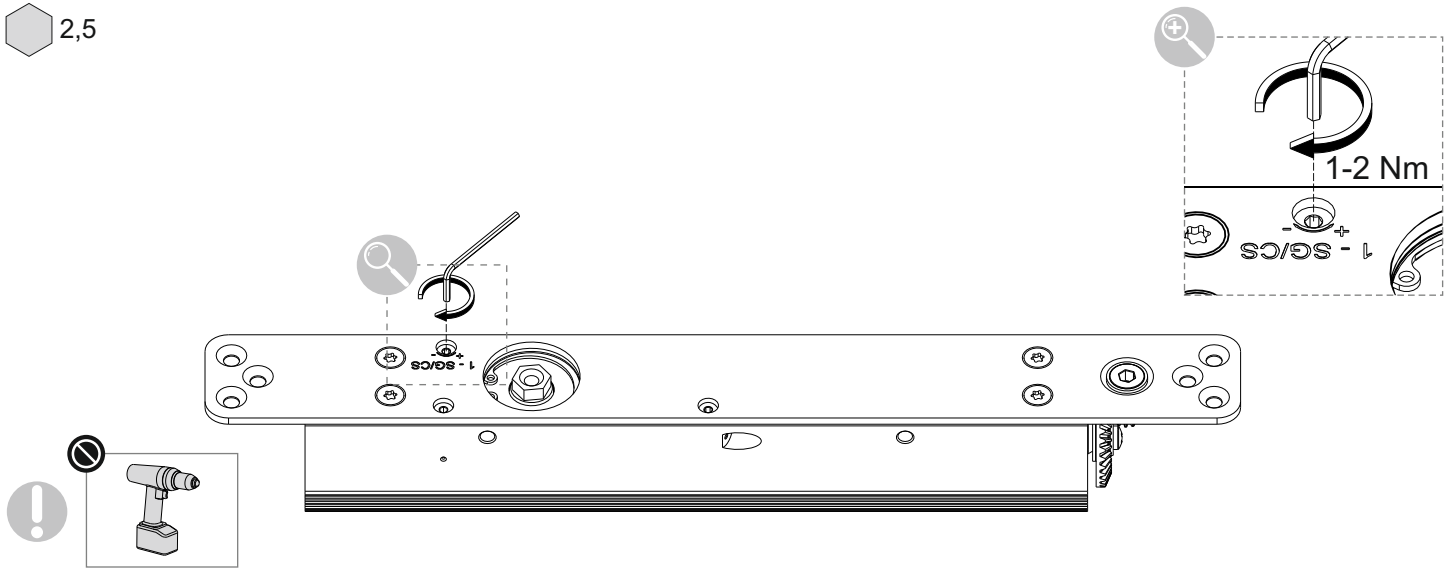

2

4

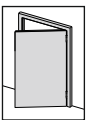
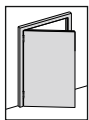
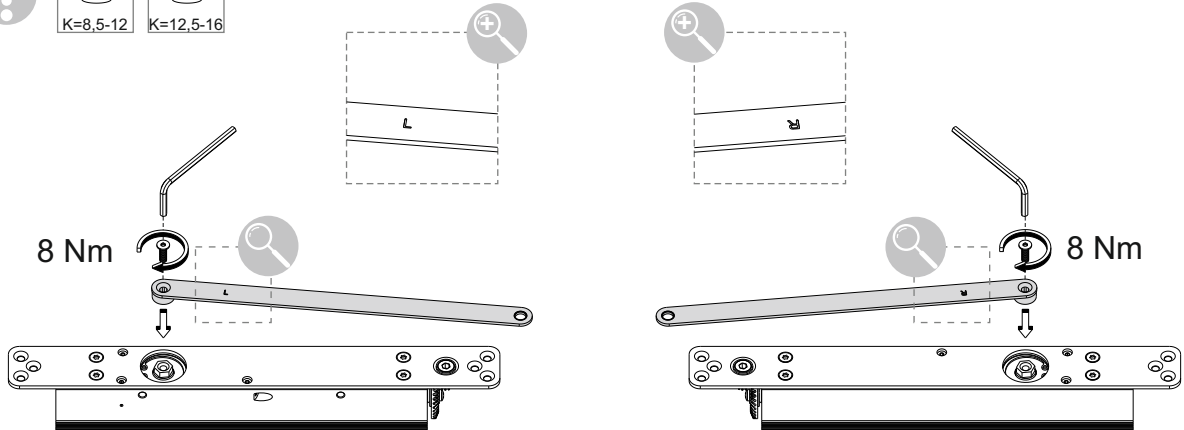

3

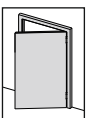
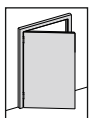
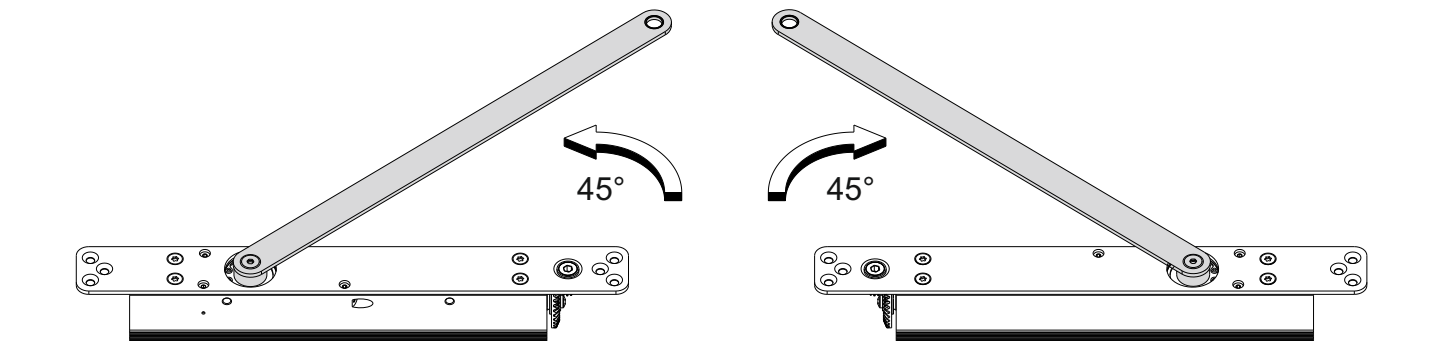

ITS-630 (3-6)

4

TX 25

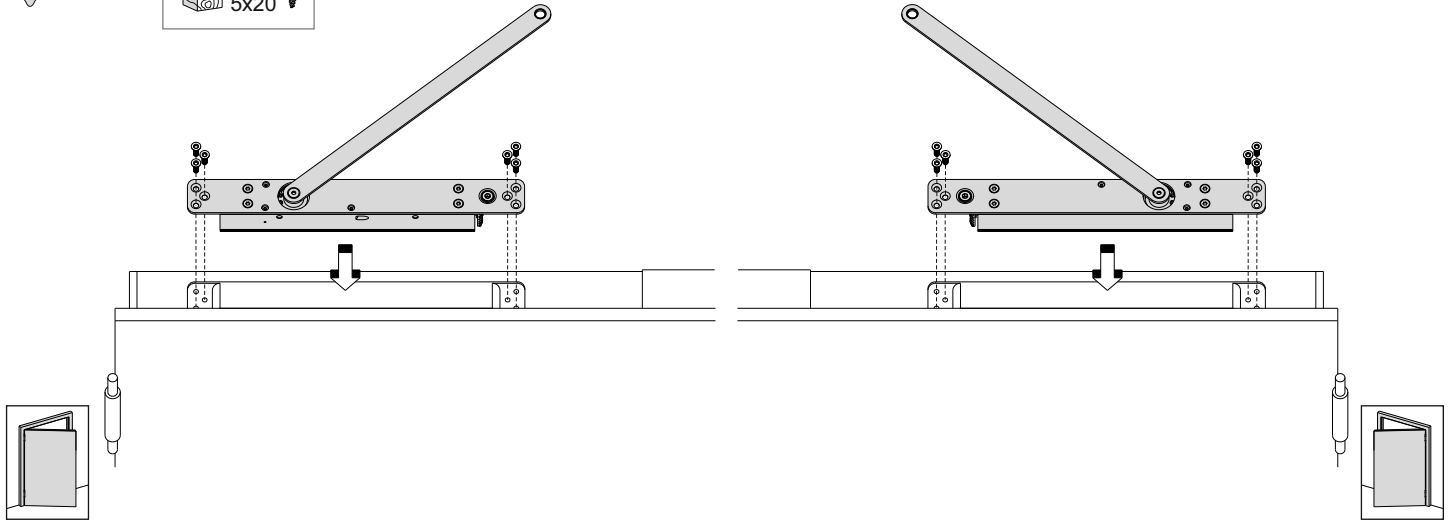

5

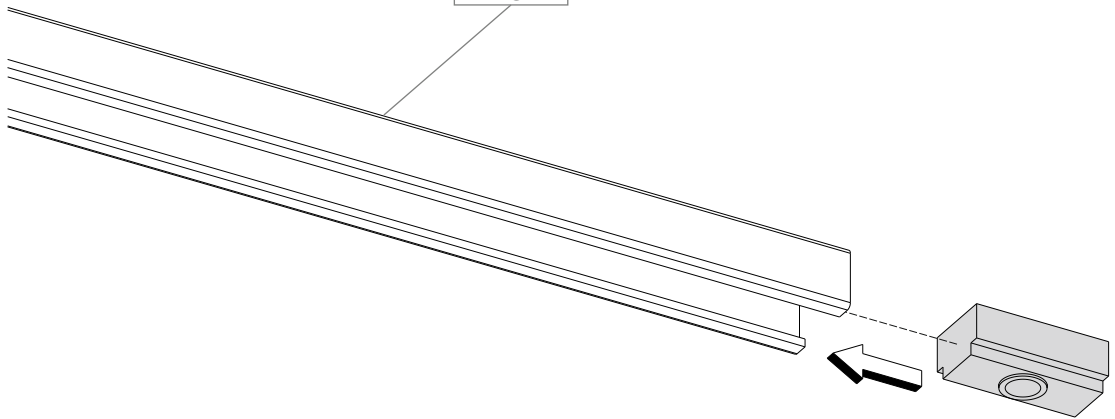
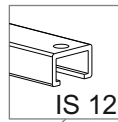

6

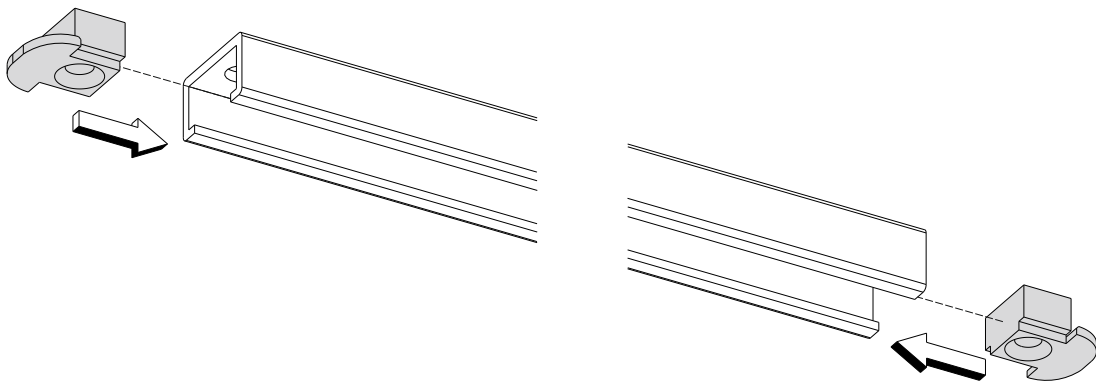

ITS-630 (3-6)

7

TX 25

2x
4,5x40

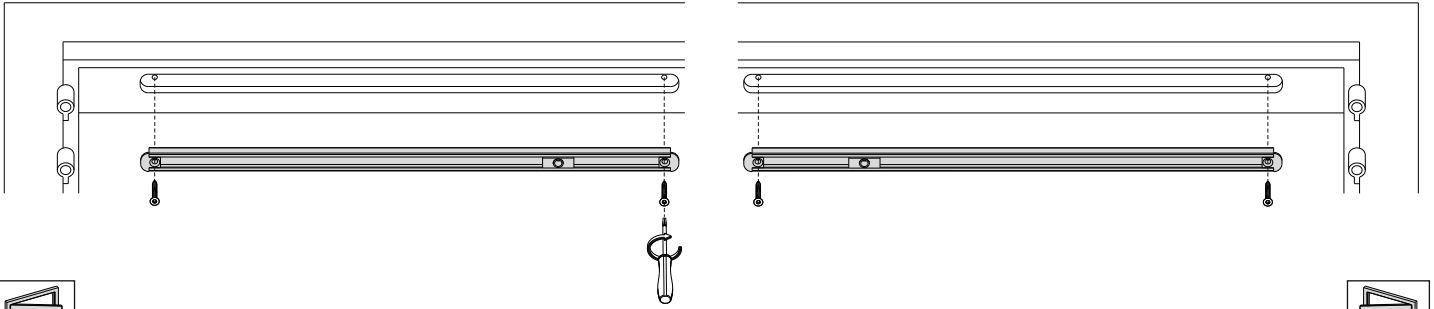

8

4

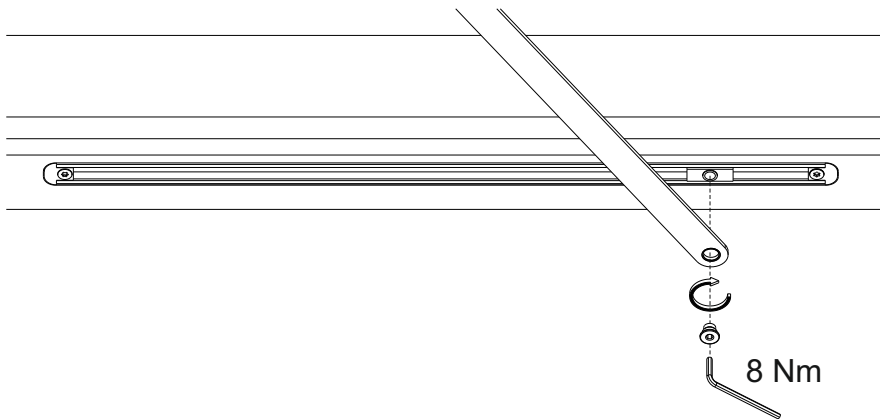

9

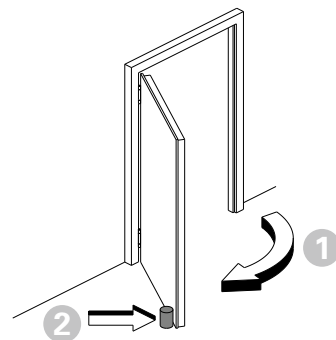
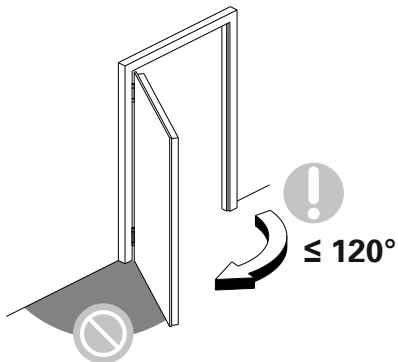

ITS-630 (3-6)

10

2,5/5

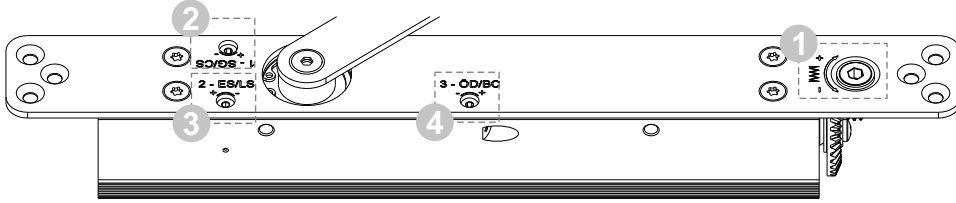

1

EN 3	4x
EN 4	10x
EN 5	26x
EN 6	40x

EN 3

2 1 - SG/CS

3 2 - ES/LS

4 3 - ÖD/BC

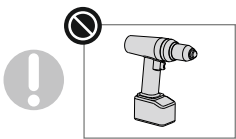

12

4

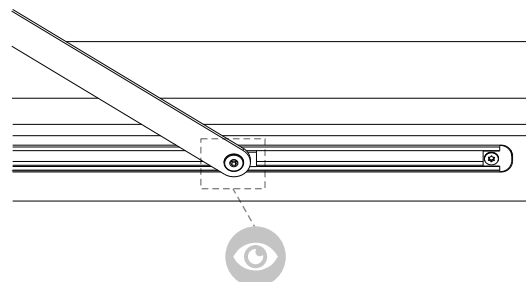
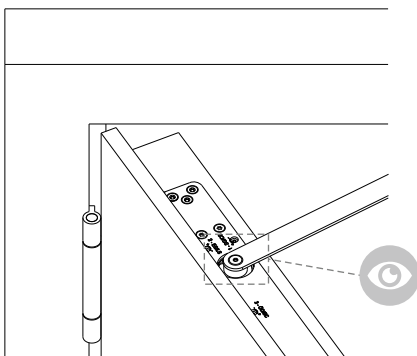

ITS-630 (3-6)

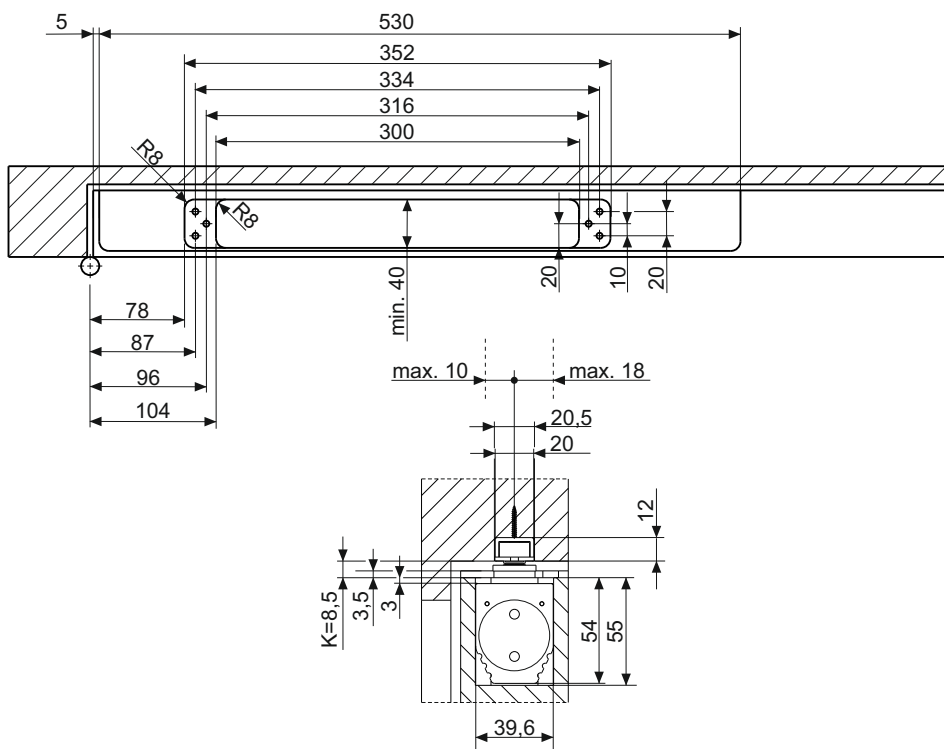
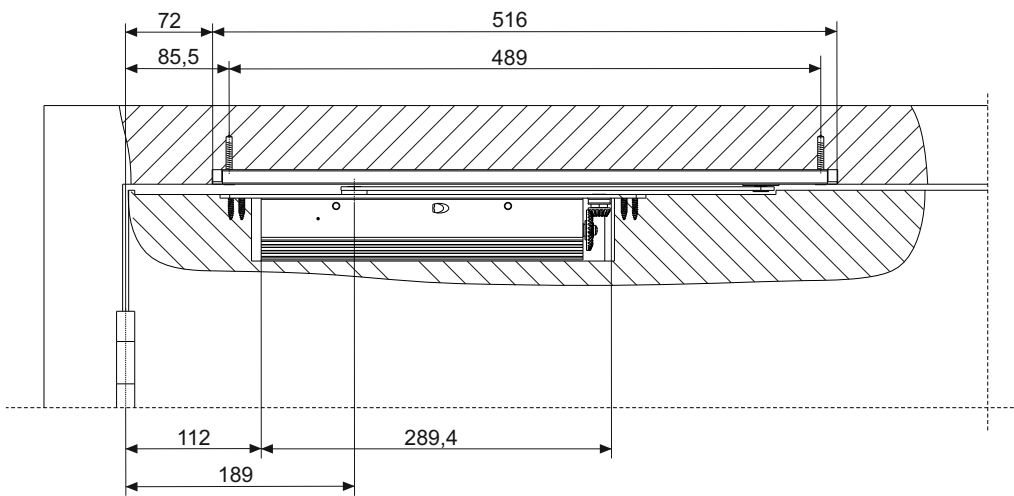
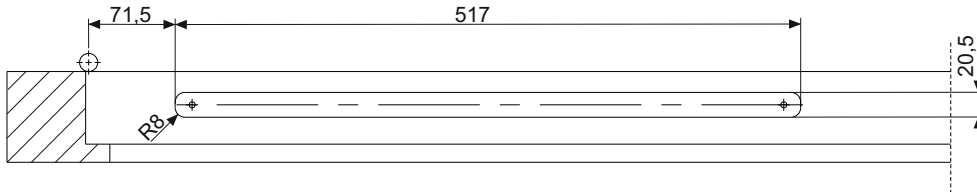
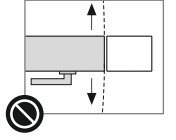
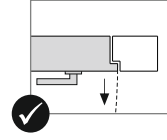

ITS-630 (3-6)

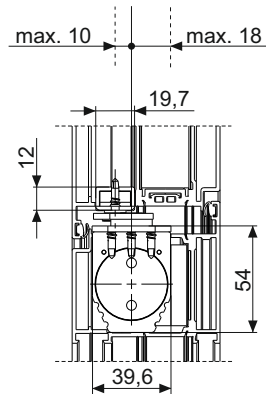
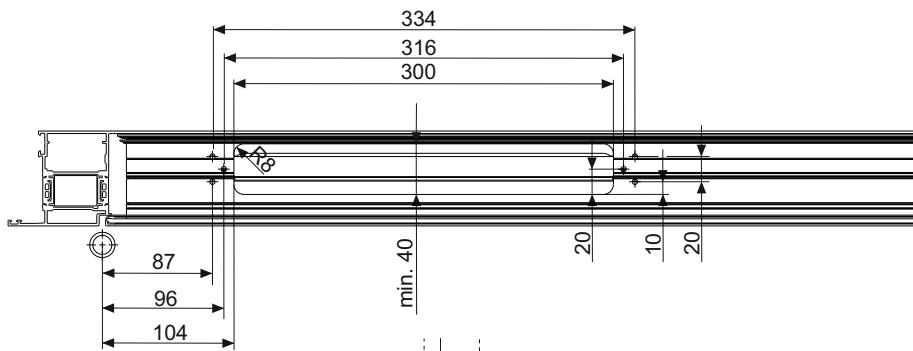
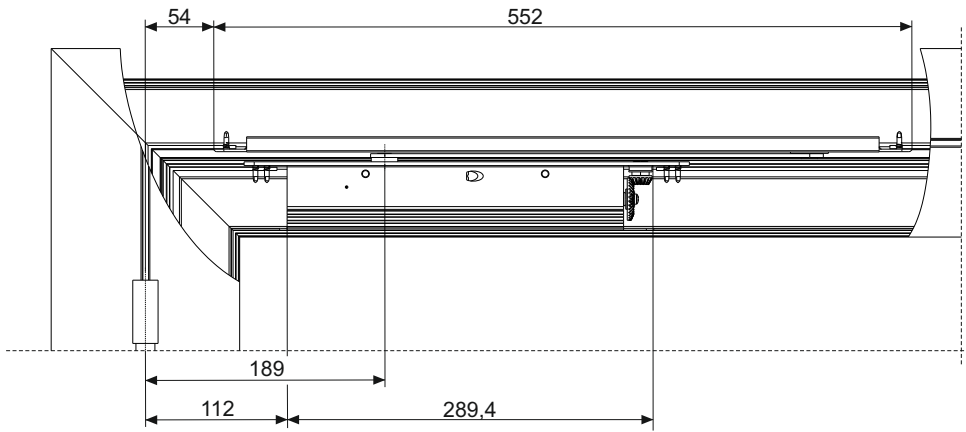
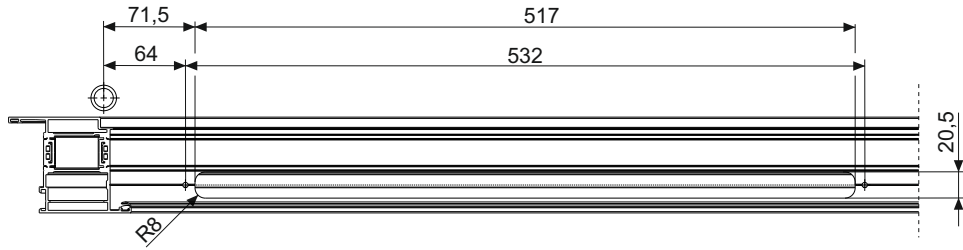
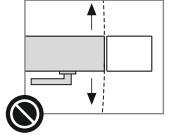
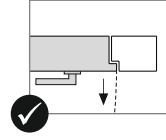

ITS-630 (3-6)



Türschließer	Zertifikat der Leistungsbeständigkeit	Klassifizierungsschlüssel
ECO ITS-630 (3-6)	0432-CPR-00099-24	3 8 3-6 1 1 3

EN 1154:1996/A1:2002/AC:2006			
Hersteller Türschließer	Notifizierte Stelle	24	CE
ECO Schulte GmbH & Co. KG Iserlohner Landstraße 89 D-58706 Menden	0432		
Verwendungszweck			
Kontrolliertes Schließen von ein- bis zweiflügeligen Drehflügeltüren für Feuerschutz-/Rauchschutzabschlüsse			
Türschließer / eindeutiger Kenncode		Leistungserklärung	
ECO ITS-630 (3-6)		DOP-1154-EN3-6-00099-24	
Wesentliche Merkmale		Leistung	
Selbstschließend			
5.2.1	Allgemeines	Bestanden	
5.2.3	Schließmoment	Größe 3-6: Bestanden	
5.2.4	Öffnungsmoment	Größe 3-6: Bestanden	
5.2.5	Wirkungsgrad	Größe 3-6: Bestanden	
5.2.6	Schließzeit	Bestanden	
5.2.7	Öffnungswinkel	Klasse 3: Bestanden (innenliegend)	
5.2.8	Überlastverhalten	Bestanden	
5.2.9	Temperaturabhängigkeit	Größe 3-6: Bestanden	
5.2.10	Flüssigkeitsaustritt	Größe 3-6: Bestanden	
5.2.11	Beschädigung	Größe 3-6: Bestanden	
5.2.12	Endschlagregulierung	Größe 3-6: Bestanden	
5.2.13	Öffnungsdämpfung	Größe 3-6: Bestanden	
5.2.14	Schließzeitverzögerung	NPD	
5.2.15	einstellbare Schließkraft	Größe 3-6: Bestanden	
5.2.16	Spiel in Nulllage	NPD	
5.2.18	Eignung für Feuer-/ Rauchschutzabschlüsse	Klasse 1: zur Verwendung an Feuer-/Rauchschutztüren gemäß Prüfung nach EN 1634-1	
Dauerfunktion des Selbstschließens			
5.2.2	Dauerfunktion	Klasse 8: 500.000 Zyklen	
5.2.17.1	Korrosionsbeständigkeit	Klasse 3: Hohe Korrosionsbeständigkeit (96h)	
5.2.17.2	Korrosionsbeständigkeit	Klasse 3: Hohe Korrosionsbeständigkeit (96h)	
5.2.17.3	Korrosionsbeständigkeit	Klasse 3: Hohe Korrosionsbeständigkeit (96h)	
Gefährliche Substanzen			
ZA.3	Gefährliche Substanzen	Die in diesem Produkt verwendeten Materialien enthalten keine gefährlichen Substanzen oder geben diese frei.	



<https://www.eco-schulte.com/service/downloads/leistungserklaerungen>

ITS-630 (3-6)



Door closer	Certificate of constancy of performance	Classification key
ECO ITS-630 (3-6)	0432-CPR-00099-24	3 8 3-6 1 1 3















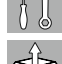

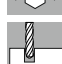









EN 1154:1996/A1:2002/AC:2006		
Manufacturer door closer	Notified body	24
ECO Schulte GmbH & Co. KG Iserlohner Landstraße 89 D-58706 Menden	0432	
CE		
Purpose of application		
Controlled closing of single- and double leafed doors for fire-/smoke resistance closures		
Door closer / Unique code for the product type		Declaration of performance
ECO ITS-630 (3-6)		DOP-1154-EN3-6-00099-24
Essential characteristics		Performance
Self-closing		
5.2.1	General	Passed
5.2.3	Closing torque	Size 3-6: Passed
5.2.4	Opening torque	Size 3-6: Passed
5.2.5	Efficiency	Size 3-6: Passed
5.2.6	Closing time	Passed
5.2.7	Opening angle	Class 3: Passed (internal montage)
5.2.8	Overload test	Passed
5.2.9	Temperature dependence	Size 3-6: Passed
5.2.10	Leakage	Size 3-6: Passed
5.2.11	Damage	Size 3-6: Passed
5.2.12	Latch regulation	Size 3-6: Passed
5.2.13	Back check	Size 3-6: Passed
5.2.14	Delayed action	NPD
5.2.15	Adjustable force	Size 3-6: Passed
5.2.16	Plat at zero point position	NPD
5.2.18	Use on fire-/smoke resistance doors	Class 1: For use on fire-/smoke resistance doors acc. to a test of EN 1634-1
Durability self-closing		
5.2.2	Durability	Vlass 8: 500.000 cycles
5.2.17.1	Corrosion resistance	Class 3: high corrosion resistance (96h)
5.2.17.2	Corrosion resistance	Class 3: high corrosion resistance (96h)
5.2.17.3	Corrosion resistance	Class 3: high corrosion resistance (96h)
Dangerous substances		
ZA.3	Dangerous substances	The materials used in this product do not contain or release any dangerous substances

















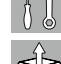













<https://www.eco-schulte.com/en/service/downloads/declarations-of-performance>

ITS-630 (3-6)

DE

-  Anleitung beachten
-  Kopfschutz verwenden
-  Handschutz verwenden
-  Augenschutz verwenden
-  Sicherheitshinweise
-  Werkzeuge
-  Lieferumfang
-  Abmessungen
-  Ventileinstellung
-  Montagemaße
-  Wartungshinweise
-  Wartungsintervall
-  Zertifikat
-  Links
-  Beachten
-  Detailansicht
-  Detailansicht vergrößert
-  Prüfen
-  Falsch
-  Richtig
-  Schließkraft
-  Schließgeschwindigkeit/Schließverzögerung
-  Zeitangabe
-  Endschlag
-  Öffnungsdämpfung
-  Schnell
-  Langsam
-  Schwer
-  Leicht

EN

-  Follow instructions
-  Use head protection
-  Use hand protection
-  Use eye protection
-  Safety instructions
-  Tools
-  Scope of delivery
-  Dimensions
-  Valve adjustment
-  Mounting dimensions
-  Maintenance instructions
-  Service interval
-  Certificate
-  Links
-  Observe
-  Detail view
-  Detail view enlarged
-  Check
-  Incorrect
-  Correct
-  Closing force
-  Closing speed/Delay action
-  Time indication
-  Latching speed
-  Back check
-  Fast
-  Slow
-  Heavy
-  Light